

Core & Coil (71A) MH

~LT~ 175W

**CORE & COIL HID MH BAL 70W M98/143 120V
C&C**

The basic ballast is the open core and coil which is most often used as a component within a lighting luminaire. The core and coil also forms the nucleus of Philips Advance's five other ballast configurations.

Product data

General Information	
ANSI Code	M98
Lamp Type	70W MH
Number of Lamps	1 piece/unit
Circuit Type	HX-PFC
Ballast Type	Magnetic HID
Base Model	71A5205P
Core Size	2 X 4
Suitable For Outdoor Use	Yes
Ignitor Catalog Number	LI533-H4
Ignitor Temperature Rating	105°C
Capacitor Value	36 MFD
Capacitor Catalog Number	7C360M12RA
Capacitor Requirements	120V
Capacitor Temperature Rating	105°C
Capacitor Diameter/Oval Dimensions	1.65 in
Capacitor Height	2.75 in
Automatic Restart	No

Operating and Electrical	
Input Voltage	120 V
Input Frequency	60 Hz
Input Current (Open Circuit)	1.4 A
Input Current (Starting)	1 A
Input Current (Short Circuit)	0.75-1.15 A
Secondary Short Circuit Current	0.85-1.25 A
Constant Wattage Deviation	10%
Ballast Factor (Nom)	1
Power Factor (Nom)	0.87
Open Circuit Voltage	255 V
Input Current (Nom)	0.85 A A
Input Power (Nom)	94 W
Rated Lamp Power	70 W
Wiring	
Wire Striplength	0.5 mm
Wire Length by Color	12"
Wire Type	Stranded
Remote Wiring Configuration Allowed	Yes

Core & Coil (71A) MH ~LT~ 175W

Max Ballast-Lamp Distance Remote Wiring	10'
Recommended Fuse Value	4 A
Approval and Application	
Open Circuit Voltage Test (Volts)	230-280 V
Approval Marks	ULR CSA certificate RoHS Compliant
Temperature Marking	B
UL Recognized	Yes
Hipot Test (1 Minute)	2000 V
Hipot Test (2 Seconds)	2500 V
UL Insulation Class	H(180°C)
UL Temperature Code	1029B

Product Data	
Order product name	CORE & COIL HID MH BAL 70W M98/143 120V C&C
EAN/UPC - Product	781087105092
Order code	913700531109
Numerator - Quantity Per Pack	1
Numerator - Packs per outer box	12
Material Nr. (12NC)	913700531109
Net Weight (Piece)	1.765 kg

Dimensional drawing

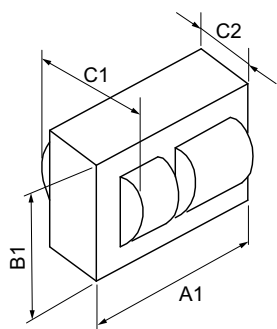

MH BAL 70W M98/143 120V C&C

Product	C1	C2	A1	B1
CORE & COIL HID 71A5205500DP	2.65 in	1.5 in	4.2 in	2.2 in

