



Core & Coil (71A) MH ~LT~ 175W

CORE & COIL HID MH BAL 150W M102/142 120/277/347V C&C

The basic ballast is the open core and coil which is most often used as a component within a lighting luminaire. The core and coil also forms the nucleus of Philips Advance's five other ballast configurations.

Product data

General Information	
ANSI Code	M102-M142
Lamp Type	150 MH
Number of Lamps	1 piece/unit
Circuit Type	SUPER-CWA
Ballast Type	Magnetic HID
Base Model	71A54A3
Core Size	3 X 4 (2 coil)
Suitable For Outdoor Use	Yes
Ignitor Catalog Number	LI501-J4
Ignitor Temperature Rating	105°C
Capacitor Value	22 MFD
Capacitor Catalog Number	7C220M24RA
Capacitor Requirements	240V
Capacitor Temperature Rating	105°C
Capacitor Diameter/Oval Dimensions	1.65 in
Capacitor Height	2.75 in
Automatic Restart	No

Operating and Electrical	
Input Voltage	120/277/347 V
Input Frequency	60 Hz
Inp. Current (Open Circuit)	1.4/0.6/0.48 A
Input Current (Starting)	0.95/0.4/0.3 A
Input Current (Short Circuit)	0.45-0.75/0.2-0.4/0.15-0.35 A
Secondary Short Circuit Current	2.4-2.9 A
Constant Wattage Deviation	10%
Ballast Factor (Nom)	1
Power Factor (Nom)	0.85
Nominal Open Circuit Voltage	187 V
Input Current (Operating) (Nom)	1.75/0.76/0.62 A A
Input Power (Nom)	189 W
Rated Lamp Watts	150 W

Wiring	
Wire Striplength	0.5 mm
Wire Length by Color	12"
Wire Type	Stranded
Remote Wiring Configuration Allowed	Yes

Core & Coil (71A) MH ~LT~ 175W

Max Ballast-Lamp Distance Remote	15'
Wiring	
Recommended Fuse Value	5/2/2 A
Approval and Application	
Open Circuit Voltage Test (Volts)	175-205 V
Approbation Marks	ULR CSA certificate RoHS Compliant
Temperature Marking	C/B/A
UL Recognized	Yes
Hipot Test (1 Minute)	2000 V
Hipot Test (2 Seconds)	2500 V
UL Insulation Class	H(180°C)
UL Temperature Code	1029C

Product Data	
Order product name	CORE & COIL HID MH BAL 150W M102/142 120/277/347V C&C
EAN/UPC - Product	781087093658
Order code	71A54A3500D
Numerator - Quantity Per Pack	1
Numerator - Packs per outer box	4
Material Nr. (12NC)	913700533709
Net Weight (Piece)	3.824 kg

Dimensional drawing

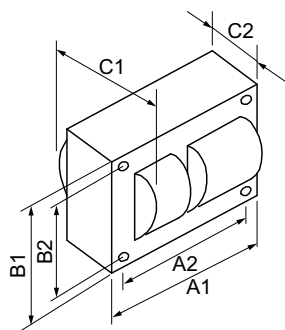

MH BAL 150W M102/142 120/277/347V C&C

Product	C1	C2	A1	A2	B1	B2
CORE & COIL HID 71A54A3500D	3.95 in	2.65 in	3.9 in	3.5 in	2.8 in	2.4 in

