



Core & Coil (71A) MH 175W – 450W

CORE & COIL HID MH BAL 400W M59 120/208/240V C&C

The basic ballast is the open core and coil which is most often used as a component within a lighting luminaire. The core and coil also forms the nucleus of Philips Advance's five other ballast configurations.

Product data

General Information		Operating and Electrical	
ANSI Code	M59	Input Voltage	120/208/240 V
Lamp Type	400W MH	Input Frequency	60 Hz
Number of Lamps	1 piece/unit	Inp. Current (Open Circuit)	4.1/2.4/2.05 A
Circuit Type	CWI	Input Current (Starting)	1.3/0.75/0.65 A
Ballast Type	Magnetic HID	Input Current (Short Circuit)	0.55–0.85/0.3–0.5/0.27–0.43 A
Base Model	71A60E6	Secondary Short Circuit Current	3.4–4.2 A
Core Size	4 1/4 x 4 3/4 (2 coil)	Constant Wattage Deviation	10%
Suitable For Outdoor Use	Yes	Ballast Factor (Nom)	1
Ignitor Catalog Number	NA	Power Factor (Nom)	0.90
Ignitor Temperature Rating	NA	Nominal Open Circuit Voltage	320 V
Capacitor Value	20 MFD	Input Current (Operating) (Nom)	4.2/2.45/2.1 A A
Capacitor Catalog Number	MD2006100	Input Power (Nom)	465 W
Capacitor Requirements	425V	Rated Lamp Watts	400 W
Capacitor Temperature Rating	90°C		
Capacitor Diameter/Oval Dimensions	1.75 in	Wiring	
Capacitor Height	3.38 in	Wire Striplength	0.5 mm
Automatic Restart	No	Wire Length by Color	12"
		Wire Type	Stranded
		Remote Wiring Configuration Allowed	Yes

Core & Coil (71A) MH 175W - 450W

Max Ballast-Lamp Distance Remote	Determined by AWG used
Wiring	
Recommended Fuse Value	10/7/5 A
Approval and Application	
Open Circuit Voltage Test (Volts)	290-360 V
Approbation Marks	ULR CSA certificate RoHS Compliant
Temperature Marking	E/D/D
UL Recognized	Yes
Hipot Test (1 Minute)	2000 V
Hipot Test (2 Seconds)	2500 V
UL Insulation Class	H(180°C)
UL Temperature Code	1029E

Product Data

Order product name	CORE & COIL HID MH BAL 400W M59 120/208/240V C&C
EAN/UPC - Product	781087048153
Order code	71A60E6500
Numerator - Quantity Per Pack	1
Numerator - Packs per outer box	3
Material Nr. (12NC)	913700536109
Net Weight (Piece)	6.564 kg

Dimensional drawing

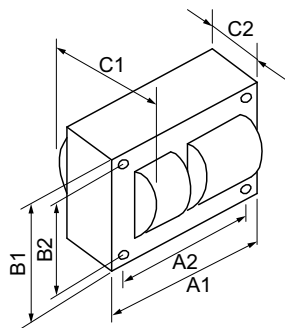

MH BAL 400W M59 120/208/240V C&C

Product	C1	C2	A1	A2	B1	B2
CORE & COIL HID 71A60E6500	4 in	2.4 in	4.8 in	4.4 in	4.3 in	3.9 in

