



Core & Coil (71A) MH

175W - 450W

**CORE & COIL HID MH BAL 400W M135/155
120/208/240V C&C**

The basic ballast is the open core and coil which is most often used as a component within a lighting luminaire. The core and coil also forms the nucleus of Philips Advance's five other ballast configurations.

Product data

General Information	
ANSI Code	M135-M155
Lamp Type	400W MH
Number of Lamps	1 piece/unit
Circuit Type	CWA
Ballast Type	Magnetic HID
Base Model	71A61E6
Core Size	4 1/4 x 4 3/4 (2 coil)
Suitable For Outdoor Use	Yes
Ignitor Catalog Number	LI533-H4
Ignitor Temperature Rating	105°C
Capacitor Value	26 MFD
Capacitor Catalog Number	7C260P33R
Capacitor Requirements	330V
Capacitor Temperature Rating	105°C
Capacitor Diameter/Oval Dimensions	1.75 in
Capacitor Height	4.8 in
Automatic Restart	No

Operating and Electrical

Input Voltage	120/208/240 V
Input Frequency	60 Hz
Inp. Current (Open Circuit)	3.8/2.2/1.9 A
Input Current (Starting)	1.3/0.75/0.65 A
Input Current (Short Circuit)	0.5-0.8/0.3-0.5/0.25-0.4 A
Secondary Short Circuit Current	3.4-4.2 A
Constant Wattage Deviation	10%
Ballast Factor (Nom)	1
Power Factor (Nom)	0.90
Nominal Open Circuit Voltage	265 V
Input Current (Operating) (Nom)	4.2/2.4/2.1 A A
Input Power (Nom)	455 W
Rated Lamp Watts	400 W

Wiring

Wire Striplength	0.5 mm
Wire Length by Color	12"
Wire Type	Stranded
Remote Wiring Configuration Allowed	Yes

Core & Coil (71A) MH 175W - 450W

Max Ballast-Lamp Distance Remote Wiring	2'
Recommended Fuse Value	10/7/5 A

Approval and Application

Open Circuit Voltage Test (Volts)	240-290 V
Approbation Marks	ULR CSA certificate RoHS Compliant
Temperature Marking	E/C/C
UL Recognized	Yes
Hipot Test (1 Minute)	2000 V
Hipot Test (2 Seconds)	2500 V
UL Insulation Class	H(180°C)
UL Temperature Code	1029E

Product Data

Order product name	CORE & COIL HID 71A61E6500D
EAN/UPC - Product	781087092699
Order code	71A61E6500D
Numerator - Quantity Per Pack	1
Numerator - Packs per outer box	4
Material Nr. (12NC)	913700536409
Net Weight (Piece)	6.065 kg

Dimensional drawing

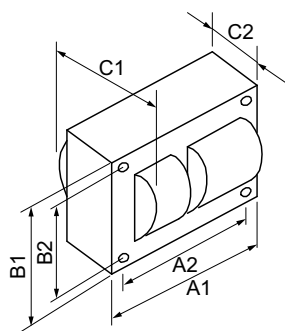

MH BAL 400W M135/155 120/208/240V C&C

Product	C1	C2	A1	A2	B1	B2
CORE & COIL HID 71A61E6500D	3.8 in	2.2 in	4.8 in	4.4 in	4.3 in	3.9 in

