



# Core & Coil (71A) MH ~GT~ 450W

The basic ballast is the open core and coil which is most often used as a component within a lighting luminaire. The core and coil also forms the nucleus of Philips Advance's five other ballast configurations.

## Product data

General Information	
ANSI Code	M47
Lamp type	1000W MH
Number of lamps	1 piece/unit
Circuit type	CWA
Ballast type	Magnetic HID
Base model	71A6542T
Core size	4 1/4 x 6 (2 Coil)
Suitable for outdoor use	Yes
Ignitor catalogue number	NA
Ignitor temperature rating	NA
Capacitor value	24 MFD
Capacitor catalogue number	MD2409000
Capacitor requirements	480V
Capacitor temperature rating	90°C
Capacitor diameter/oval dimensions	1.75 in
Capacitor height	3.9 in
Automatic restart	No

Operating and Electrical	
Input voltage	480/120T V
Input frequency	60 Hz
Input current (open circuit)	1.2 A
Input current (starting)	1.9 A

Input current (short circuit)	1.4-2.15 V
Secondary short-circuit current	5.2-6.4 A
Constant wattage deviation	10%
Ballast factor (nom.)	1
Power factor (nom.)	0.90
Open circuit voltage	430 V
Input current (nom.)	2.25 A A
Input power (nom.)	1080 W
Rated lamp power	1000 W

Wiring	
Wire strip length	0.5 mm
Wire length by colour	12"
Wire type	Stranded
Remote wiring configuration allowed	Yes
Max. ballast-lamp distance remote wiring	Determined by AWG used
Recommended fuse value	6 A

Approval and Application	
Open circuit voltage test (volts)	385-475 V
Approval marks	ULR CSA certificate RoHS Compliant
Temperature marking	D
UL recognised	Yes
Hipot test (1 minute)	2000 V

## Core & Coil (71A) MH ~GT~ 450W

Hipot test (2 seconds)	2500 V
UL insulation class	H(180°C)
UL temperature code	1029D
<b>Product Data</b>	
Order product name	CORE & COIL HID MH BAL 1000W M47 480V/120T KIT

EAN/UPC – product	781087022399
Numerator – quantity per pack	1
Numerator – packs per outer box	1
Material no. (12NC)	913700536709
Net weight (piece)	9.658 kg

### Dimensional drawing

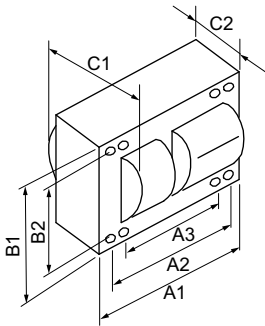

MH BAL 1000W M47 480V/120T KIT

Product	C1	C2	A1	A2	A3	B1	B2
CORE & COIL HID MH BAL 1000W M47 480V/120T KIT	4.5 in	2.6 in	6 in	5.4 in	4.4 in	4.3 in	3.9 in

