



# Core & Coil (71A) HPS ~LT~ 200W

## CORE & COIL HID HPS BAL 35W S76 120V C&C

The basic ballast is the open core and coil which is most often used as a component within a lighting luminaire. The core and coil also forms the nucleus of Philips Advance's five other ballast configurations.

### Product data

General Information			
ANSI Code	S76	Input Frequency	60 Hz
Lamp Type	35W HPS	Input Current (Open Circuit)	0.65 A
Number of Lamps	1 piece/unit	Input Current (Starting)	0.78 A
Circuit Type	R-HPF	Input Current (Short Circuit)	0.45-0.65 A
Ballast Type	Magnetic HID	Secondary Short Circuit Current	0.9-1.4 A
Base Model	71A7707	Constant Wattage Deviation	Within Trapezoid
Core Size	2 5/8 x 2 3/16	Ballast Factor (Nom)	1
Suitable For Outdoor Use	Yes	Power Factor (Nom)	0.90
Ignitor Catalog Number	LI551-H4	Open Circuit Voltage	120 V
Ignitor Temperature Rating	105°C	Input Current (Nom)	0.38 A A
Capacitor Value	14 MFD	Input Power (Nom)	46 W
Capacitor Catalog Number	7C140L12RA	Rated Lamp Power	35 W
Capacitor Requirements	120V	Wiring	
Capacitor Temperature Rating	105°C	Wire Striplength	0.5 mm
Capacitor Diameter/Oval Dimensions	1.25 in	Wire Length by Color	12"
Capacitor Height	2.25 in	Wire Type	Stranded
Automatic Restart	No	Remote Wiring Configuration Allowed	Yes
Operating and Electrical		Max Ballast-Lamp Distance Remote Wiring	2'
Input Voltage	120 V	Recommended Fuse Value	2 A

## Core & Coil (71A) HPS ~LT~ 200W

### Approval and Application

Open Circuit Voltage Test (Volts)	114-126 V
Approval Marks	ULR CSA certificate RoHS Compliant
Temperature Marking	A
UL Recognized	Yes
Hipot Test (1 Minute)	2000 V
Hipot Test (2 Seconds)	2500 V
UL Insulation Class	H(180°C)
UL Temperature Code	1029A

### Product Data

Order product name	CORE & COIL HID HPS BAL 35W S76 120V C&C
--------------------	--

EAN/UPC - Product	781087770757
Order code	913700537409
Numerator - Quantity Per Pack	1
Numerator - Packs per outer box	8
Material Nr. (12NC)	913700537409
Net Weight (Piece)	0.672 kg

### Dimensional drawing

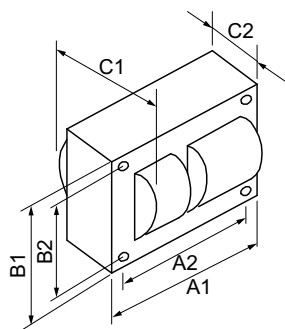

HPS BAL 35W S76 120V C&C

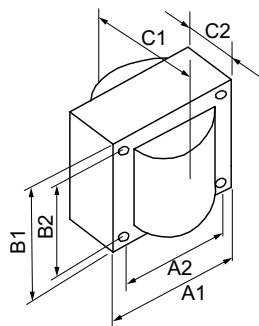

HPS BAL 35W S76 120V C&C

Product	C1	C2	A1	A2	B1	B2
CORE & COIL HID 71A7707500D	1.8 in	0.65 in	2.6 in	2.2 in	2.2 in	1.8 in

Product	C1	C2	A1	A2	B1	B2
CORE & COIL HID 71A7707500D	1.8 in	0.65 in	2.6 in	2.2 in	2.2 in	1.8 in

## Core & Coil (71A) HPS ~LT~ 200W

