



Core & Coil (71A) HPS ~LT~ 200W

The basic ballast is the open core and coil which is most often used as a component within a lighting luminaire. The core and coil also forms the nucleus of Philips Advance's five other ballast configurations.

Product data

General Information	
ANSI Code	S62
Lamp type	70W HPS
Number of lamps	1 piece/unit
Circuit type	HX-HPF
Ballast type	Magnetic HID
Base model	71A7941
Core size	3 X 4 (2 coil)
Suitable for outdoor use	Yes
Ignitor catalogue number	LI551-H4
Ignitor temperature rating	105°C
Capacitor value	7 MFD
Capacitor catalogue number	7C070L30RA
Capacitor requirements	280V
Capacitor temperature rating	105°C
Capacitor diameter/oval dimensions	1.25 in
Capacitor height	2.75 in
Automatic restart	No

Operating and Electrical	
Input voltage	480 V
Input frequency	60 Hz
Input current (open circuit)	0.36 A
Input current (starting)	0.21 A

Input current (short circuit)	0.15-0.25 A
Secondary short-circuit current	1.8-2.2 A
Constant wattage deviation	Within Trapezoid
Ballast factor (nom.)	1
Power factor (nom.)	0.90
Open circuit voltage	120 V
Input current (nom.)	0.21 A A
Input power (nom.)	93 W
Rated lamp power	70 W

Wiring	
Wire strip length	0.5 mm
Wire length by colour	12"
Wire type	Stranded
Remote wiring configuration allowed	Yes
Max. ballast-lamp distance remote wiring	2'
Recommended fuse value	2 A

Approval and Application	
Open circuit voltage test (volts)	110-130 V
Approval marks	ULR CSA certificate RoHS Compliant
Temperature marking	A
UL recognised	Yes
Hipot test (1 minute)	2000 V

Core & Coil (71A) HPS ~LT~ 200W

Hipot test (2 seconds)	2500 V
UL insulation class	H(180°C)
UL temperature code	1029A
Product Data	
Order product name	CORE & COIL HID HPS BAL 70W S62 480V C&C

EAN/UPC – product	781087794159
Numerator – quantity per pack	1
Numerator – packs per outer box	6
Material no. (12NC)	913700537909
Net weight (piece)	2.763 kg

Dimensional drawing

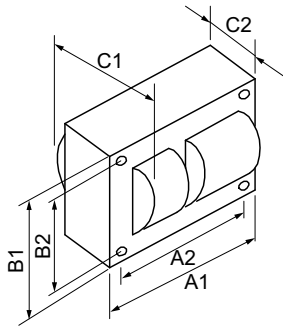

HPS BAL 70W S62 480V C&C

Product	C1	C2	A1	A2	B1	B2
CORE & COIL HID HPS BAL 70W S62 480V C&C	3.2 in	1.85 in	3.9 in	3.5 in	2.8 in	2.4 in

