



Core & Coil (71A) HPS ~LT~ 200W

CORE & COIL HID HPS BAL 150W S55 120/208/240V C&C

The basic ballast is the open core and coil which is most often used as a component within a lighting luminaire. The core and coil also forms the nucleus of Philips Advance's five other ballast configurations.

Product data

General Information		Operating and Electrical	
ANSI Code	S55	Input Voltage	120/208/240 V
Lamp Type	150W HPS	Input Frequency	60 Hz
Number of Lamps	1 piece/unit	Input Current (Open Circuit)	1/0.6/0.5 A
Circuit Type	CWI	Input Current (Starting)	0.9/0.5/0.45 A
Ballast Type	Magnetic HID	Input Current (Short Circuit)	0.4-0.7/0.23-0.4/0.2-0.35 A
Base Model	71A81E6	Secondary Short Circuit Current	3.75-4.65 A
Core Size	3 X 4 (2 coil)	Constant Wattage Deviation	Within Trapezoid
Suitable For Outdoor Use	Yes	Ballast Factor (Nom)	1
Ignitor Catalog Number	LI551-J4	Power Factor (Nom)	0.90
Ignitor Temperature Rating	105°C	Open Circuit Voltage	105 V
Capacitor Value	52 MFD	Input Current (Nom)	1.76/1.01/0.88 A A
Capacitor Catalog Number	7C520P24RA	Input Power (Nom)	190 W
Capacitor Requirements	240V	Rated Lamp Power	150 W
Capacitor Temperature Rating	105°C		
Capacitor Diameter/Oval Dimensions	1.85 in	Wiring	
Capacitor Height	3.7 in	Wire Striplength	0.5 mm
Automatic Restart	No	Wire Length by Color	12"
		Wire Type	Stranded
		Remote Wiring Configuration Allowed	Yes

Core & Coil (71A) HPS ~LT~ 200W

Max Ballast-Lamp Distance Remote	2'
Wiring	
Recommended Fuse Value	5/3/3 A
Approval and Application	
Open Circuit Voltage Test (Volts)	95-115 V
Approval Marks	ULR CSA certificate RoHS Compliant
Temperature Marking	E/E/D
UL Recognized	Yes
Hipot Test (1 Minute)	2000 V
Hipot Test (2 Seconds)	2500 V
UL Insulation Class	H(180°C)
UL Temperature Code	1029E

Product Data	
Order product name	CORE & COIL HID HPS BAL 150W S55 120/208/240V C&C
EAN/UPC - Product	781087050101
Order code	193425
Local order code	193425
Numerator - Quantity Per Pack	1
Numerator - Packs per outer box	4
Material Nr. (12NC)	913700538909
Net Weight (Piece)	3.833 kg

Dimensional drawing

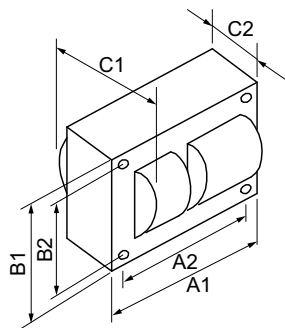

HPS BAL 150W S55 120/208/240V C&C

Product	C1	C2	A1	A2	B1	B2
CORE & COIL HID 71A81E6500D	4 in	2.6 in	3.9 in	3.5 in	2.8 in	2.4 in

