

## Core & Coil (71A) HPS ~LT~ 200W

**CORE & COIL HID HPS BAL 150W S55  
120/208/240V C&C**

The basic ballast is the open core and coil which is most often used as a component within a lighting luminaire. The core and coil also forms the nucleus of Philips Advance's five other ballast configurations.

## Product data

General Information	
ANSI Code	S55
Lamp Type	150W HPS
Number of Lamps	1 piece/unit
Circuit Type	CWI
Ballast Type	Magnetic HID
Base Model	71A81E6
Core Size	3 X 4 (2 coil)
Suitable For Outdoor Use	Yes
Ignitor Catalog Number	LI551-J4
Ignitor Temperature Rating	105°C
Capacitor Value	52 MFD
Capacitor Catalog Number	7C520P24RA
Capacitor Requirements	240V
Capacitor Temperature Rating	105°C
Capacitor Diameter/Oval Dimensions	1.85 in
Capacitor Height	3.7 in
Automatic Restart	No

Operating and Electrical	
Input Voltage	120/208/240 V
Input Frequency	60 Hz
Imp. Current (Open Circuit)	1/0.6/0.5 A
Input Current (Starting)	0.9/0.5/0.45 A
Input Current (Short Circuit)	0.4-0.7/0.23-0.4/0.2-0.35 A
Secondary Short Circuit Current	3.75-4.65 A
Constant Wattage Deviation	Within Trapezoid
Ballast Factor (Nom)	1
Power Factor (Nom)	0.90
Nominal Open Circuit Voltage	105 V
Input Current (Operating) (Nom)	1.76/1.01/0.88 A A
Input Power (Nom)	190 W
Rated Lamp Watts	150 W
Wiring	
Wire Striplength	0.5 mm
Wire Length by Color	12"
Wire Type	Stranded
Remote Wiring Configuration Allowed	Yes

## Core & Coil (71A) HPS ~LT~ 200W

Max Ballast-Lamp Distance Remote	2'
Wiring	
Recommended Fuse Value	5/3/3 A
<b>Approval and Application</b>	
Open Circuit Voltage Test (Volts)	95-115 V
Approbation Marks	ULR CSA certificate RoHS Compliant
Temperature Marking	E/E/D
UL Recognized	Yes
Hipot Test (1 Minute)	2000 V
Hipot Test (2 Seconds)	2500 V
UL Insulation Class	H(180°C)
UL Temperature Code	1029E

<b>Product Data</b>	
Order product name	CORE & COIL HID HPS BAL 150W S55 120/208/240V C&C
EAN/UPC - Product	781087050101
Order code	71A81E6500D
Numerator - Quantity Per Pack	1
Numerator - Packs per outer box	4
Material Nr. (12NC)	913700538909
Net Weight (Piece)	3.833 kg

### Dimensional drawing

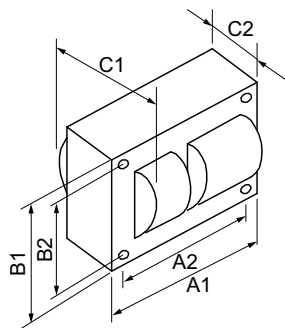

HPS BAL 150W S55 120/208/240V C&C

Product	C1	C2	A1	A2	B1	B2
CORE & COIL HID 71A81E6500D	4 in	2.6 in	3.9 in	3.5 in	2.8 in	2.4 in

