



# Core & Coil (71A) MH ~LT~ 175W

## CORE & COIL HID MH BAL 100W M90/140 120/277/347V C&C

The basic ballast is the open core and coil which is most often used as a component within a lighting luminaire. The core and coil also forms the nucleus of Philips Advance's five other ballast configurations.

### Product data

| General Information                |                | Operating and Electrical            |                             |
|------------------------------------|----------------|-------------------------------------|-----------------------------|
| ANSI Code                          | M90-M140       | Input Voltage                       | 120/277/347 V               |
| Lamp Type                          | 100 MH         | Input Frequency                     | 60 Hz                       |
| Number of Lamps                    | 1 piece/unit   | Input Current (Open Circuit)        | 2.6/1.15/1 A                |
| Circuit Type                       | HX-HPF         | Input Current (Starting)            | 1.15/0.5/0.4 A              |
| Ballast Type                       | Magnetic HID   | Input Current (Short Circuit)       | 0.7-1.2/0.3-0.5/0.25-0.45 A |
| Base Model                         | 71A53A0        | Secondary Short Circuit Current     | 1.3-1.6 A                   |
| Core Size                          | 3 X 4 (2 coil) | Constant Wattage Deviation          | 12%                         |
| Suitable For Outdoor Use           | Yes            | Ballast Factor (Nom)                | 1                           |
| Ignitor Catalog Number             | LI533-H4       | Power Factor (Nom)                  | 0.90                        |
| Ignitor Temperature Rating         | 105°C          | Open Circuit Voltage                | 280 V                       |
| Capacitor Value                    | 12 MFD         | Input Current (Nom)                 | 1.15/0.5/0.4 A A            |
| Capacitor Catalog Number           | 7C120M30RA     | Input Power (Nom)                   | 129 W                       |
| Capacitor Requirements             | 280V           | Rated Lamp Power                    | 100 W                       |
| Capacitor Temperature Rating       | 105°C          |                                     |                             |
| Capacitor Diameter/Oval Dimensions | 1.65 in        | Wiring                              |                             |
| Capacitor Height                   | 2.75 in        | Wire Striplength                    | 0.5 mm                      |
| Automatic Restart                  | No             | Wire Length by Color                | 12"                         |
|                                    |                | Wire Type                           | Stranded                    |
|                                    |                | Remote Wiring Configuration Allowed | Yes                         |

## Core & Coil (71A) MH ~LT~ 175W

|                                   |                                    |
|-----------------------------------|------------------------------------|
| Max Ballast-Lamp Distance Remote  | 25'                                |
| Wiring                            |                                    |
| Recommended Fuse Value            | 6/3/2 A                            |
| <b>Approval and Application</b>   |                                    |
| Open Circuit Voltage Test (Volts) | 250-315 V                          |
| Approval Marks                    | ULR CSA certificate RoHS Compliant |
| Temperature Marking               | B/B/B                              |
| UL Recognized                     | Yes                                |
| Hipot Test (1 Minute)             | 2000 V                             |
| Hipot Test (2 Seconds)            | 2500 V                             |
| UL Insulation Class               | H(180°C)                           |
| UL Temperature Code               | 1029B                              |

|                                 |  |
|---------------------------------|--|
| <b>Product Data</b>             |  |
| Order product name              | CORE & COIL HID MH BAL 100W M90/140 120/277/347V C&C |
| EAN/UPC - Product               | 781087047309   |
| Order code                      | 913700572309   |
| Numerator - Quantity Per Pack   | 1  |
| Numerator - Packs per outer box | 6  |
| Material Nr. (12NC)             | 913700572309   |
| Net Weight (Piece)              | 2.672 kg   |

### Dimensional drawing

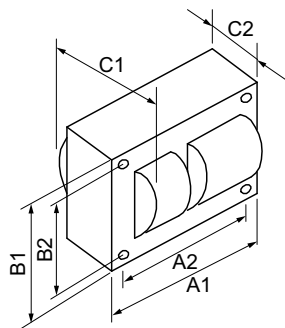

MH BAL 100W M90/140 120/277/347V C&C

| Product  | C1     | C2     | A1     | A2     | B1     | B2     |
|--|--------|--------|--------|--------|--------|--------|
| CORE & COIL HID MH BAL 100W M90/140 120/277/347V C&C | 2.9 in | 1.7 in | 3.9 in | 3.5 in | 2.8 in | 2.4 in |

