



# Core & Coil (71A) HPS ~LT~ 200W

## CORE & COIL HID HPS BAL 150W S55 QUAD C&C

The basic ballast is the open core and coil which is most often used as a component within a lighting luminaire. The core and coil also forms the nucleus of Philips Advance's five other ballast configurations.

### Product data

General Information			
ANSI Code	S55	Input Frequency	60 Hz
Lamp Type	150W HPS	Input Current (Open Circuit)	2.8/1.6/1.4/1.25 A
Number of Lamps	1 piece/unit	Input Current (Starting)	2/1.15/1/0.85 A
Circuit Type	HX-HPF	Input Current (Short Circuit)	1.15-1.75/0.65-1/0.55-0.85/0.5-0.75 A
Ballast Type	Magnetic HID	Secondary Short Circuit Current	3.95-4.85 A
Base Model	71A8192	Constant Wattage Deviation	Within Trapezoid
Core Size	3 X 4 (2 LW)	Ballast Factor (Nom)	1
Suitable For Outdoor Use	Yes	Power Factor (Nom)	0.90
Ignitor Catalog Number	LI551-H4	Open Circuit Voltage	120 V
Ignitor Temperature Rating	105°C	Input Current (Nom)	1.65/0.95/0.83/0.72 A A
Capacitor Value	14 MFD	Input Power (Nom)	190 W
Capacitor Catalog Number	7C140M30RA	Rated Lamp Power	150 W
Capacitor Requirements	280V	Wiring	
Capacitor Temperature Rating	105°C	Wire Striplength	0.5 mm
Capacitor Diameter/Oval Dimensions	1.65 in	Wire Length by Color	12"
Capacitor Height	2.75 in	Wire Type	Stranded
Automatic Restart	No	Remote Wiring Configuration Allowed	Yes
Operating and Electrical		Max Ballast-Lamp Distance Remote	2'
Input Voltage	120/208/240/277 V	Wiring	

## Core & Coil (71A) HPS ~LT~ 200W

Recommended Fuse Value	10/5/5/4 A
<b>Approval and Application</b>	
Open Circuit Voltage Test (Volts)	110-130 V
Approval Marks	ULR CSA certificate RoHS Compliant
Temperature Marking	E/E/E/E
UL Recognized	Yes
Hipot Test (1 Minute)	2000 V
Hipot Test (2 Seconds)	2500 V
UL Insulation Class	H(180°C)
UL Temperature Code	1029E

<b>Product Data</b>	
Order product name	CORE & COIL HID HPS BAL 150W S55 QUAD C&C
EAN/UPC - Product	781087819258
Order code	505727
Local order code	505727
Numerator - Quantity Per Pack	1
Numerator - Packs per outer box	4
Material Nr. (12NC)	913700577109
Net Weight (Piece)	3.493 kg

### Dimensional drawing

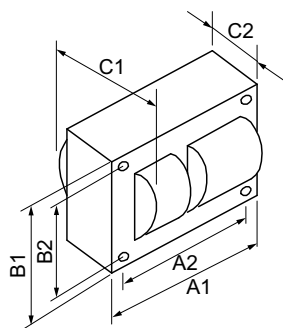

Product	C1	C2	A1	A2	B1	B2
CORE & COIL HID HPS BAL 150W S55 QUAD C&C	4.2 in	2.5 in	3.9 in	3.5 in	2.8 in	2.4 in

HPS BAL 150W S55 QUAD C&C

