



PrimaVision Power for CDM

HID-PV C 150 /S CDM 220-240V 50/60Hz

PrimaVision Power gear is designed for optimal performance of 100 and 150 W CDM lamps – ideal where high-intensity light is key.

Product data

Operating and Electrical		Mechanical and Housing	
Input Voltage	220 to 240 V	Housing	/S
Line Frequency	50 to 60 Hz		
Input Frequency	50 to 60 Hz		
Earth Leakage Current (Max)	0.35 mA		
Inrush Current Width	.50 ms		
Inrush Current Peak (Max)	50 A		
Number of Products on MCB (16A Type B) (Nom)	6		
Wiring		Approval and Application	
Cable Length From Device to Lamp	78-3/4 inch	Approval Marks	F-Marking CE marking VDE certificate VDE-EMV certificate CB Certificate
Connector Type	Insert		
Temperature		Product Data	
Ambient temperature range	-4 °F to 140 °F	Order product name	HID-PV C 150 /S CDM 220-240V 50/60Hz
T-Case Lifetime (Nom)	167 °F	Full product name	HID-PV C 150 /S CDM 220-240V 50/60Hz
T-Case Maximum (Max)	185 °F	Full product code	871150091052330
		Order code	913700614066
		Material Nr. (12NC)	913700614066
		Numerator - Quantity Per Pack	1
		EAN/UPC - Product/Case	8711500910523
		Numerator - Packs per outer box	12
		EAN/UPC - Case	8711500910530

PrimaVision Power for CDM

Dimensional drawing

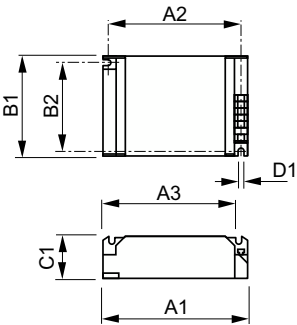

Product	D1	C1	A1	A2	B1	B2
HID-PV C 150 /S CDM	3/16	1-1/4	5-5/16	4-7/8	3 inch	2-1/2
220-240V 50/60Hz	inch	inch	inch	inch		inch

