



# HF-Performer II Xtreme for TL5/TL-D lamps

## HF-P Xt 258 TL-D EII 220-240V 50/60Hz

Enhance the quality of applications with robust driver technology. HF-Performer Xtreme is a unique X-technology from Philips that guarantees the longest lifetime and highest reliability under the harshest conditions. The ballast is primarily designed for Indoor application. For outdoor application, the luminaire should be minimum Classland need to be sufficiently protected against water & dust. The installation should also be guard against any lightening surge or any other necessary electrical protection as deemed in such typical installation & application.

### Product data

<b>Operating and Electrical</b>		<b>Connector Type Output Terminals</b>	
Input Voltage	220 to 240 V	WAGO 251 universal connector [Suitable for both automatic wiring (ALF and ADS) and manual wiring]	
Line Frequency	50 to 60 Hz		
Input Frequency	50 to 60 Hz	<b>Temperature</b>	
Inrush Current Width	0.350 ms	Ambient temperature range	
Inrush Current Peak (Max)	31 A	T-Case Lifetime (Nom)	
Number of Products on MCB (16A Type B) (Nom)	12	T-Case Maximum (Max)	
<b>Wiring</b>		<b>Mechanical and Housing</b>	
Connector Type Input Terminals	WAGO 251 universal connector [Suitable for both automatic wiring (ALF and ADS) and manual wiring]	Housing	
		L 360x30x28	
		<b>Approval and Application</b>	
		Ingress protection code	
		Energy Efficiency Index	
		IP20 [Finger-protected]	
		A2	

# HF-Performer II Xtreme for TL5/TL-D lamps

Safety Standard	IEC 61347-2-3
Environmental Standard	ISO 14001
Approval Marks	CE marking ENEC certificate VDE-EMV certificate

## Product Data

Order product name	HF-P Xt 258 TL-D EII 220-240V 50/60Hz
Full product name	HF-P Xt 258 TL-D EII 220-240V 50/60Hz
Full product code	871150091206030

Order code	913700618066
Material Nr. (12NC)	913700618066
Numerator - Quantity Per Pack	1
EAN/UPC - Product/Case	8711500912060
Numerator - Packs per outer box	12
EAN/UPC - Case	8711500912077

## Dimensional drawing

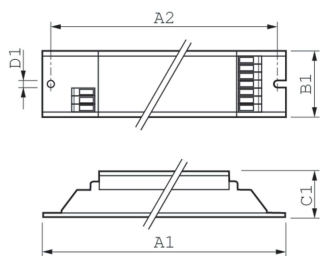

Product	D1	C1	A1	A2	B1
HF-P Xt 258 TL-D EII 220-240V 50/60Hz	4.2 mm	28.0 mm	360.0 mm	350.0 mm	30.0 mm

