

PHILIPS

Lighting



HF-Performer II Xtreme for TL5/TL-D lamps

HF-P XT 249 TL5 EII 220-240V 50/60HZ

Enhance the quality of applications with robust driver technology HF-Performer Xtreme is a unique X-technology from Philips that guarantees the longest lifetime and highest reliability under the harshest conditions.

Product data

General Information		Earth leakage current (nom.)	
Application code	EII		0.5 mA
Type version	mk1	Inrush current width	0.310 ms
Lamp type	TL5	Constant wattage deviation	-2%/+2%
Number of lamps	2 piece/unit	Ballast factor (nom.)	1.00
Number of products on MCB (16 A type B) (nom.)	12	Power losses (nom.)	9.0 W
Automatic restart	Yes	Inrush current peak (max.)	33 A
Operating and Electrical		Wiring	
Input voltage	220 to 240 V	Connector type input terminals	WAGO 251 universal connector [Suitable for both automatic wiring (ALF and ADS) and manual wiring]
Input frequency	50 to 60 Hz	Cable capacity output wires mutual (nom.)	200 pF
Operating frequency (min.)	42 kHz	Connector type output terminals	WAGO 251 universal connector [Suitable for both automatic wiring (ALF and ADS) and manual wiring]
Ignition method	Warm Start	Wire strip length	8.0-9.0 mm
Crest factor (max.)	1.7	Input terminal cross section	0.50-1.00 mm ²
Power factor 100% load (nom.)	0.96	Output terminal cross section	0.50-1.00 mm ²
Ignition time (max.)	2.0 s	Auto Insert (ALF/ADS) Wire Cross Section	0.5 mm ²
Mains voltage performance (AC)	-8%~+6%		
Mains voltage safety (AC)	-10%~+10%		

HF-Performer II Xtreme for TL5/TL-D lamps

Cable capacity output wires to earth (nom.)	200 pF
System characteristics	
Rated ballast-lamp power	49 W
Rated lamp power on TL5	49 W
System power on TL5	58 W
Lamp power on TL5	49 W
Power loss on TL5	9 W
Temperature	
T ambient (max.)	60 °C
T ambient (min.)	-25 °C
T storage (max.)	80 °C
T storage (min.)	-25 °C
T case lifetime (nom.)	75 °C
T-Case maximum (max.)	75 °C
T-Ignition (max.)	60 °C
T-Ignition (min.)	-25 °C
Mechanical and Housing	
Housing	L 360x30x28
Emergency Operation	
Battery voltage lamp ignition	198 V
Battery voltage lamp operation	176-254
Approval and Application	
Energy efficiency index	A2
IP classification	IP 20 [Ingress Protection 20]

EMI 9 kHz... 30 MHz	EN55015
EMI 30 MHz... 1,000 MHz	EN55022 level B
Safety standard	IEC 61347-2-3
Performance standard	IEC 60929
Quality standard	ISO 9000:2000
Environmental standard	ISO 14001
Harmonic current emission standard	IEC 61000-3-2
EMC immunity standard	IEC 61547
Vibration standard	IEC68-2-6 F c
Bumps standard	IEC 68-2-29 Eb
Humidity standard	EN 61347-2-3 clause 11
Approval marks	CE marking ENEC certificate VDE-EMV certificate
Temperature marking	Yes
Emergency standard	IEC 60598-2-22
Humming and noise level	Inaudible

Product Data

Full product code	871150091427930
Order product name	HF-P Xt 249 TL5 EII 220-240V 50/60Hz
EAN/UPC – product	8711500914279
Order code	91427930
Numerator – quantity per pack	1
Numerator – packs per outer box	12
Material no. (12NC)	913700629866
Net weight (piece)	0.360 kg

Dimensional drawing

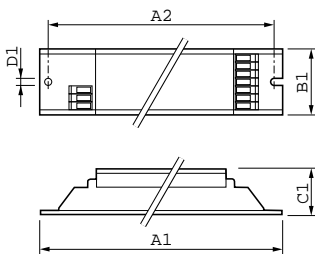

HF-P Xt 249 TL5 EII 220-240V 50/60Hz

Product	D1	C1	A1	A2	B1
HF-P Xt 249 TL5 EII 220-240V 50/60Hz	4.2 mm	28.0 mm	360.0 mm	350.0 mm	30.0 mm

HF-Performer II Xtreme for TL5/TL-D lamps

