



SDU for regulating systems

SDU 01/L 220-240V 50/60Hz

One-step dimming for easy energy savings Interface for two-level control (line-switch) of electronic gear with a 1-10 V dimming interface

Warnings and Safety

- IMPORTANT: Electronic gear is no longer galvanically isolated when SDU is connected to the dim input

Product data

Operating and Electrical	
Input Voltage	220 to 240 V
Line Frequency	50 to 60 Hz
Input Frequency	50 to 60 Hz
Wiring	
Connector Type	Screw
Temperature	
Ambient temperature range	-25 °C to 60 °C
T-Case Maximum (Max)	85 °C
Controls and Dimming	
Control Interface	Control-line
Mechanical and Housing	
Housing	STUD-89

Approval and Application	
Safety Standard	IEC 61347-2-11
Environmental Standard	ISO 14001
Approval Marks	CE marking ENEC certificate
Product Data	
Order product name	SDU-01/L 220-240V 50/60Hz
Full product name	SDU 01/L 220-240V 50/60Hz
Full product code	872790080086900
Order code	80086900
Material Nr. (12NC)	913700637166
Numerator - Quantity Per Pack	1
EAN/UPC - Product/Case	8711500880819
Numerator - Packs per outer box	20
EAN/UPC - Case	8727900800869

SDU for regulating systems

Dimensional drawing

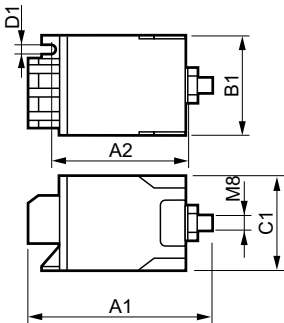

Product	D1	C1	A1	A2	B1
SDU-01/L 220-240V 50/60Hz	4.3 mm	38.0 mm	89.0 mm	70.0 mm	41.0 mm

