

PHILIPS

Lighting

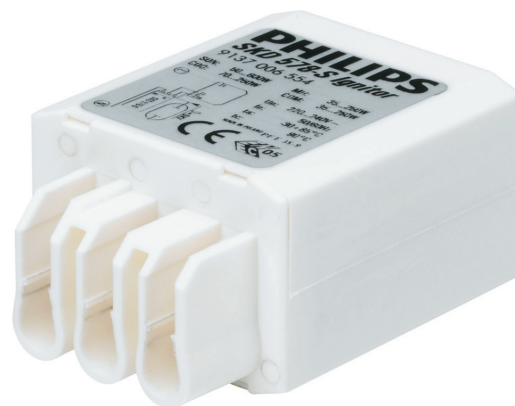

HID ignitors for MK4 semi-parallel systems

SKD 578-S 220-240V 50/60Hz

HID ignitors for semi-parallel systems

Product data

| General Information | |
|---------------------|------------------------|
| Application code | 578-S |
| Lamp type | SON/CDM/MH/HPI/HPA/CDO |
| Number of lamps | 1 piece/unit |

| Operating and Electrical | |
|--------------------------------|---------------|
| Input Voltage | 220 to 240 V |
| Input frequency | 50 to 60 Hz |
| Ignition type | Semi-Parallel |
| Ignition attempts | 3 |
| Number of ignition pulses | 1 |
| Ignition time (max.) | 1185 s |
| Ignition voltage (max.) | 5.00 kV |
| Ignition voltage (min.) | 1.80 kV |
| Response voltage | 190 V |
| Mains voltage performance (AC) | -8%~+6% |
| Mains voltage safety (AC) | -10%~+10% |
| Power losses (nom.) | 0.5 W |

| Wiring | |
|------------------------------------|---------------------------|
| Wire strip length | 6.0 mm |
| Ballast contact wire cross section | 0.50-2.50 mm ² |

| | |
|----------------|-------|
| Connector type | Screw |
|----------------|-------|

| System characteristics | |
|--------------------------|----------|
| Rated ballast-lamp power | 35-600 W |

| Temperature | |
|-----------------------|--------|
| T-ambient (max.) | 85 °C |
| T-ambient (min.) | -30 °C |
| T storage (max.) | 85 °C |
| T storage (min.) | -35 °C |
| T-Case maximum (max.) | 90 °C |

| Approval and Application | |
|--------------------------|-----------------------------|
| Approval marks | CE marking ENEC certificate |

| Product Data | |
|-----------------------------------|----------------------------|
| Full product code | 872790089569800 |
| Order product name | SKD 578-S 220-240V 50/60Hz |
| EAN/UPC – product | 8711500881779 |
| Order code | 89569800 |
| SAP numerator – quantity per pack | 1 |
| Numerator – packs per outer box | 20 |
| SAP material | 913700655466 |

HID ignitors for MK4 semi-parallel systems

SAP net weight (piece)

31.400 g

Dimensional drawing

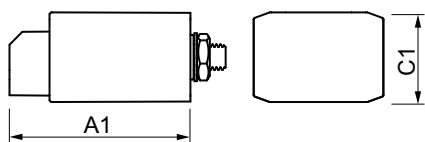
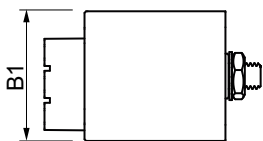

SKD 578-S 220-240V 50/60Hz

| Product | A1 | B1 | C1 |
|----------------------------|---------|---------|---------|
| SKD 578-S 220-240V 50/60Hz | 67.5 mm | 40.5 mm | 28.0 mm |

