



# DynaVision Programmable Xtreme for CDMe

## HID-DV PROG Xt 210 CDMe/CPO C2 208-277V

Highly reliable and flexible electronic drivers for MASTERColour CDMe MW lamps; designed to save on energy costs via integrated controls and to reduce maintenance costs thanks to 80,000 hour lifetime and integrated lightning protection. The DynaVision Programmable product family is the perfect basis for any sort of lighting management solution.

### Product data

Operating and Electrical	
Input Voltage	208-240-277 V
Line Frequency	50 to 60 Hz
Input Frequency	50 to 60 Hz
Power Factor 50% Load (Min)	0.98
Earth Leakage Current (Max)	0.7 mA
Inrush Current Width	4 ms
Input Current (Nom)	1.11 A
Inrush Current Peak (Max)	4 A
Number of Products on MCB (16A Type B) (Nom)	13
Wiring	
Cable Length From Device to Lamp	3 m
Connector Type	WAGO series 804

Temperature	
Ambient temperature range	-30 °C to 50 °C
T-Case Lifetime (Nom)	80 °C
Controls and Dimming	
Control Interface	PROG
Mechanical and Housing	
Housing	C2
Approval and Application	
Surge Protection (Common/Differential)	EN61547 (L-L 2kV, L-G 4kV), 10 kV TIL
Safety Standard	IEC 607, 609, 926, 928 [No Standard for HID Lamp drivers exists. Requirements in these standards to be used if considered relevant for the product.]
Environmental Standard	ISO 14001

DynaVision Programmable Xtreme for CDMe

Approval Marks	F-Marking CE marking ENEC certificate VDE-EMV certificate
Product Data	
Order product name	HID-DV PROG Xt 210 CDMe/CPO C2 208-277V
Full product name	HID-DV PROG Xt 210 CDMe/CPO C2 208-277V
Full product code	871829122269900
Order code	913700676966

Material Nr. (12NC)	913700676966
Numerator - Quantity Per Pack	1
EAN/UPC - Product/Case	8718291222699
Numerator - Packs per outer box	6
EAN/UPC - Case	8718291222705

Dimensional drawing

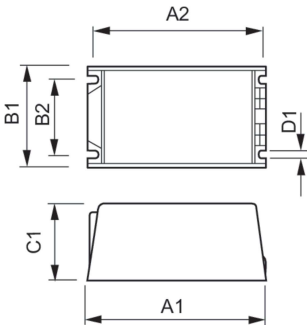

Product	D1	C1	A1	A2	B1	B2
HID-DV PROG Xt 210 CDMe/CPO C2 208-277V	4.8 mm	58.0 mm	169.0 mm	156.0 mm	100.0 mm	81.5 mm

