



HF-Regulator Intelligent Touch DALI for TL5/TL-D/PL-L lamps

HF-Ri TD 4 14/24 TL5 E+ 195-240V

This intelligent high-frequency electronic dimming ballast utilizes the DALI or Touch and Dim push-button protocol for fluorescent lamps. It meets A1BAT requirements, thereby pre-empting upcoming legislation. With a special command you can retrieve the system's mains power consumption, and with another you can find out which lamp wattage is connected. Combined with controls, additional energy savings can be achieved.

Product data

| Operating and Electrical | |
|--|-------------|
| Input Voltage | 195-240 V |
| Line Frequency | 50 to 60 Hz |
| Input Frequency | 50 to 60 Hz |
| Earth Leakage Current (Max) | 0.5 mA |
| Inrush Current Width | 0.26 ms |
| Inrush Current Peak (Max) | 31 A |
| Number of Products on MCB (16A Type B) (Nom) | 16 |

| Wiring | |
|---------------------------------|---|
| Connector Type Input Terminals | WAGO 251 universal connector [Suitable for both automatic wiring (ALF and ADS) and manual wiring] |
| Connector Type Output Terminals | WAGO 251 universal connector [Suitable for both automatic wiring (ALF and ADS) and manual wiring] |
| Temperature | |
| Ambient temperature range | -25 °C to 50 °C |
| T-Case Lifetime (Max) | 75 °C |
| T-Case Maximum (Max) | 75 °C |

HF-Regulator Intelligent Touch DALI for TL5/TL-D/PL-L lamps

| Controls and Dimming | |
|--------------------------|---|
| Control Interface | TD |
| Mechanical and Housing | |
| Housing | L 360x39x22 |
| Approval and Application | |
| Ingress protection code | IP20 [Finger-protected] |
| Energy Efficiency Index | A1 BAT |
| Safety Standard | IEC 61347-2-3 |
| Environmental Standard | ISO 14001 |
| Approval Marks | CE marking ENEC certificate VDE-EMV certificate |

| Product Data | |
|---------------------------------|----------------------------------|
| Order product name | HF-Ri TD 4 14/24 TL5 E+ 195-240V |
| Full product name | HF-Ri TD 4 14/24 TL5 E+ 195-240V |
| Full product code | 871829115678900 |
| Order code | 15678900 |
| Material Nr. (12NC) | 913700679166 |
| Numerator - Quantity Per Pack | 1 |
| EAN/UPC - Product/Case | 8718291156789 |
| Numerator - Packs per outer box | 10 |
| EAN/UPC - Case | 8718291156796 |

Dimensional drawing

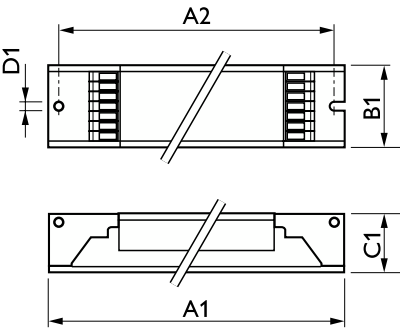

| Product | D1 | C1 | A1 | A2 | B1 |
|----------------------------------|--------|---------|----------|----------|---------|
| HF-Ri TD 4 14/24 TL5 E+ 195-240V | 4.2 mm | 22.0 mm | 360.0 mm | 350.0 mm | 39.0 mm |

