



# HF-Regulator Intelligent Touch DALI for TL5/TL-D/PL-L lamps

## HF-Ri TD 1 35/49/80 TL5 E+ 195-240V

This intelligent high-frequency electronic dimming ballast utilizes the DALI or Touch and Dim push-button protocol for fluorescent lamps. It meets A1BAT requirements, thereby pre-empting upcoming legislation. With a special command you can retrieve the system's mains power consumption, and with another you can find out which lamp wattage is connected. Combined with controls, additional energy savings can be achieved.

### Product data

Operating and Electrical		Wiring	
Input Voltage	195-240 V	Connector type input terminals	WAGO 251 universal connector [Suitable for both automatic wiring (ALF and ADS) and manual wiring]
Line Frequency	50 to 60 Hz	Connector type output terminals	WAGO 251 universal connector [Suitable for both automatic wiring (ALF and ADS) and manual wiring]
Input frequency	50 to 60 Hz		
Earth leakage current (max.)	0.5 mA		
Inrush current width	0.25 ms		
Inrush current peak (max.)	28 A		
Number of products on MCB (16 A type B) (nom.)	18		
		Temperature	
		Ambient temperature range	-25°C to 50°C
		T case lifetime (max.)	75 °C
		T-Case maximum (max.)	75 °C

## HF-Regulator Intelligent Touch DALI for TL5/TL-D/PL-L lamps

### Controls and Dimming

Control interface	TD
-------------------	----

### Mechanical and Housing

Housing	L 359x30x21
---------	-------------

### Approval and Application

Ingress protection code	IP20 [Finger-protected]
Energy efficiency index	A1 BAT
Safety standard	IEC 61347-2-3
Environmental standard	ISO 14001
Approval marks	CE marking ENEC certificate VDE-EMV certificate

### Product Data

Order product name	HF-Ri TD 1 35/49/80 TL5 E+ 195-240V
Full product name	HF-Ri TD 1 35/49/80 TL5 E+ 195-240V
Full EOC	871829166207500
Order code	66207500
Material no. (12 NC)	913700695766
Local order code	HFRITD13580T5PL
SAP numerator – quantity per pack	1
EAN/UPC – Product/Case	8718291662075
Numerator – packs per outer box	12
EAN/UPC – Case	8718291662082

### Dimensional drawing

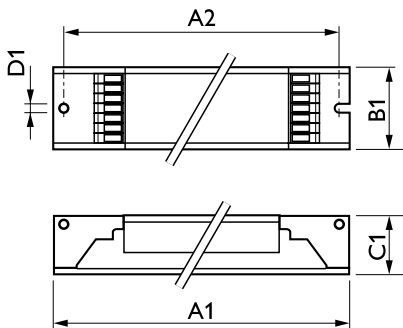

Product	D1	C1	A1	A2	B1
HF-Ri TD 1 35/49/80 TL5 E+ 195-240V	4.1 mm	22.0 mm	360.0 mm	350.0 mm	30.0 mm

