

PHILIPS

Lighting

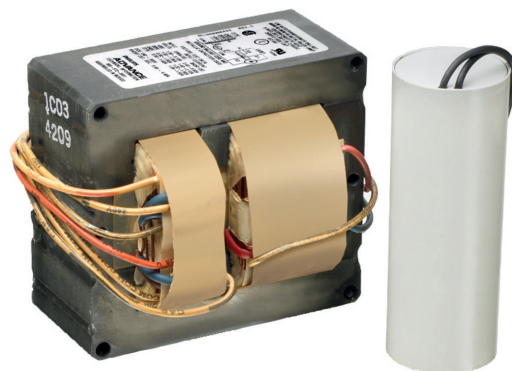

Core & Coil (71A) MH 175W - 450W

The basic ballast is the open core and coil which is most often used as a component within a lighting luminaire. The core and coil also forms the nucleus of Philips Advance's five other ballast configurations.

Product data

General Information

ANSI Code	M59
Lamp type	400W MH
Number of lamps	1 piece/unit
Circuit type	CWA
Ballast type	Magnetic HID
Base model	71A60H1A
Core size	4 1/4 x 4 3/4 (2 coil)
Suitable for outdoor use	Yes
Ignitor catalogue number	NA
Ignitor temperature rating	NA
Capacitor value	24 MFD
Capacitor catalogue number	7C240P40R
Capacitor requirements	400V
Capacitor temperature rating	105°C
Capacitor diameter/oval dimensions	1.75 in
Capacitor height	4.8 in
Automatic restart	No

Operating and Electrical

Input voltage	127/220 V
Input frequency	60 Hz
Input current (open circuit)	3.11/1.8 A
Input current (starting)	2.74/1.56 A

Input current (short circuit)	2.45-3.9/1.4-2.2 A
Secondary short-circuit current	3.5-4.3 A
Constant wattage deviation	10%
Ballast factor (nom.)	1
Power factor (nom.)	0.90
Open circuit voltage	300 V
Input current (nom.)	3.9/2.2 A A
Input power (nom.)	454 W
Rated lamp power	400 W

Wiring

Wire strip length	0.5 mm
Wire length by colour	12"
Wire type	Stranded
Remote wiring configuration allowed	Yes
Max. ballast-lamp distance remote wiring	Determined by AWG used
Recommended fuse value	10/7 A

Approval and Application

Open circuit voltage test (volts)	270-330 V
Approval marks	NOM certificate RoHS Compliant CSA certificate
Temperature marking	F/F
UL recognised	Yes

Core & Coil (71A) MH 175W - 450W

Hipot test (1 minute)	2000 V
Hipot test (2 seconds)	2500 V
UL insulation class	H(180°C)
UL temperature code	1029F

Product Data

Order product name	CORE & COIL HID MH BAL 400W M59 127/220V C&C
--------------------	---

EAN/UPC – product	781087084540
Numerator – quantity per pack	1
Numerator – packs per outer box	2
Material no. (12NC)	913701113209
Net weight (piece)	5.657 kg

Dimensional drawing

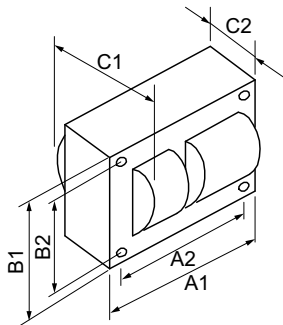

MH BAL 400W M59 127/220V C&C

Product	C1	C2	A1	A2	B1	B2
CORE & COIL HID MH BAL 400W M59 127/220V C&C	4.05 in	2.14 in	4.8 in	4.4 in	4.3 in	3.9 in

