

Core & Coil (71A) HPS ~LT~ 200W

CORE & COIL HID HPS BAL 100W (EURO LAMP)
127/220/240 C&C

The basic ballast is the open core and coil which is most often used as a component within a lighting luminaire. The core and coil also forms the nucleus of Philips Advance's five other ballast configurations.

Product data

General Information	
ANSI Code	SON-TPIA
Lamp Type	100W HPS
Number of Lamps	1 piece/unit
Circuit Type	CWA
Ballast Type	Magnetic HID
Base Model	71A99J9
Core Size	4 x 4 (2 coil)
Suitable For Outdoor Use	Yes
Ignitor Catalog Number	LI533-H4
Ignitor Temperature Rating	105°C
Capacitor Value	11 MFD
Capacitor Catalog Number	7C110M40
Capacitor Requirements	370V
Capacitor Temperature Rating	105°C
Capacitor Diameter/Oval Dimensions	1.65 in
Capacitor Height	3.75 in
Automatic Restart	No

Operating and Electrical

Input Voltage	127/220/240 V
Input Frequency	60 Hz
Inp. Current (Open Circuit)	0.52/0.3/0.27 A
Input Current (Starting)	0.64/0.37/0.34 A
Input Current (Short Circuit)	0.39–0.58/0.17–0.33/0.2–0.31 A
Secondary Short Circuit Current	1.4–1.8 A
Constant Wattage Deviation	10%
Ballast Factor (Nom)	1
Power Factor (Nom)	0.90
Nominal Open Circuit Voltage	200 V
Input Current (Operating) (Nom)	0.97/0.55/0.51 A A
Input Power (Nom)	120 W
Rated Lamp Watts	100 W

Wiring

Wire Striplength	0.5 mm
Wire Length by Color	12"
Wire Type	Stranded
Remote Wiring Configuration Allowed	Yes

Core & Coil (71A) HPS ~LT~ 200W

Max Ballast-Lamp Distance Remote Wiring	2'
Recommended Fuse Value	2/2/2 A
Approval and Application	
Open Circuit Voltage Test (Volts)	190-210 V
Approbation Marks	FIDE Certificate NOM certificate RoHS Compliant
Temperature Marking	A/A/A
UL Recognized	No
Hipot Test (1 Minute)	2000 V
Hipot Test (2 Seconds)	2500 V
UL Insulation Class	H(180°C)

UL Temperature Code	1029A
Product Data	
Order product name	CORE & COIL HID HPS BAL 100W (EURO LAMP) 127/220/240 C&C
EAN/UPC - Product	781087122105
Order code	71A99J9500DML
Numerator - Quantity Per Pack	1
Numerator - Packs per outer box	2
Material Nr. (12NC)	913701148902
Net Weight (Piece)	3.843 kg

Dimensional drawing

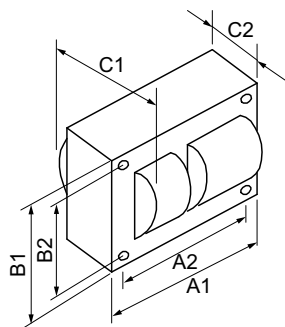

HPS BAL 100W (EURO LAMP) 127/220/240 C&C

Product	C1	C2	A1	A2	B1	B2
CORE & COIL HID 71A99J9500DML	3.75 in	2.48 in	4.8 in	4.4 in	4.3 in	3.9 in

