



Core & Coil (71A) HPS 200W - 400W

CORE & COIL HID HPS BAL 250W S50 230V C&C

The basic ballast is the open core and coil which is most often used as a component within a lighting luminaire. The core and coil also forms the nucleus of Philips Advance's five other ballast configurations.

Product data

General Information			
ANSI Code	S50	Input Frequency	60 Hz
Lamp Type	250W HPS	Inp. Current (Open Circuit)	0.9 A
Number of Lamps	1 piece/unit	Input Current (Starting)	0.76 A
Circuit Type	CWA	Input Current (Short Circuit)	0.5-0.8 A
Ballast Type	Magnetic HID	Secondary Short Circuit Current	3.7-4.5 A
Base Model	71A82J3	Constant Wattage Deviation	Within Trapezoid
Core Size	4 x 4 (2 coil)	Ballast Factor (Nom)	1
Suitable For Outdoor Use	Yes	Power Factor (Nom)	0.90
Ignitor Catalog Number	LI501-H4	Nominal Open Circuit Voltage	188 V
Ignitor Temperature Rating	105°C	Input Current (Operating) (Nom)	1.31 A A
Capacitor Value	35 MFD	Input Power (Nom)	293 W
Capacitor Catalog Number	7C350P24RA	Rated Lamp Watts	250 W
Capacitor Requirements	240V	Wiring	
Capacitor Temperature Rating	105°C	Wire Striplength	0.5 mm
Capacitor Diameter/Oval Dimensions	1.65 in	Wire Length by Color	12"
Capacitor Height	3.7 in	Wire Type	Stranded
Automatic Restart	No	Remote Wiring Configuration Allowed	Yes
Operating and Electrical		Max Ballast-Lamp Distance Remote Wiring	5'
Input Voltage	230 V	Recommended Fuse Value	4 A

Core & Coil (71A) HPS 200W - 400W

Approval and Application

Open Circuit Voltage Test (Volts)	170-205 V
Approbation Marks	ULR RoHS Compliant SASO Certificate
Temperature Marking	B
UL Recognized	Yes
Hipot Test (1 Minute)	2000 V
Hipot Test (2 Seconds)	2500 V
UL Insulation Class	H(180°C)
UL Temperature Code	1029B

Product Data

Order product name	CORE & COIL HID HPS BAL 250W S50 230V C&C
--------------------	---

EAN/UPC - Product	781087129548
Order code	71A82J3500D
Numerator - Quantity Per Pack	1
Numerator - Packs per outer box	4
Material Nr. (12NC)	913701150802
Net Weight (Piece)	4.976 kg

Dimensional drawing

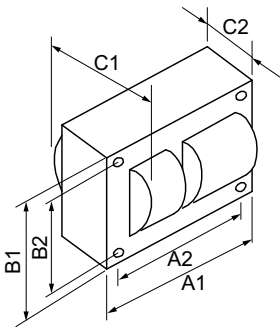

HPS BAL 250W S50 230V C&C

Product	C1	C2	A1	A2	B1	B2
CORE & COIL HID HPS BAL 250W S50 230V C&C	3.4 in	1.8 in	4.8 in	4.4 in	4.3 in	3.9 in

