

# HID-Basic BHL for HPL/HPI (India)

## BHL 250 X261

Impregnated electromagnetic ballasts of copper and steel construction for High-Pressure Mercury Vapor (HPL) lamps

### Product data

General Information	
Application Code	250 X261
Lamp Type	HPL/HPI/HPI-T
Number of Lamps	1 piece/unit
Operating and Electrical	
Input Voltage	240 V
Input Frequency	50 Hz
Mains Voltage Performance (AC)	240+6%--8%
Mains Voltage Safety (AC)	240-10%+10%
Input Current with PF Correction	1.32 A
Input Current without PF Correction	2.15 A
Power Factor with PF Compensation	0.85
Power Factor without PF Compensation (Nom)	0.52
Power Losses (Nom)	22 W
Wiring	
Connector Type	Screw
System characteristics	
Rated Ballast-Lamp Power	250 W

Temperature	
T-Winding (Max)	130 °C
Delta-T Normal Conditions	75 °C
Approval and Application	
Energy Efficiency Index	Not specified
Approval Marks	CE marking
Product Data	
Full product code	871150088452700
Order product name	BHL 250 X261
EAN/UPC - Product	8711500884527
Order code	913702253012
Numerator - Quantity Per Pack	1
Numerator - Packs per outer box	4
Material Nr. (12NC)	913702253012
Net Weight (Piece)	2.110 kg

## HID-Basic BHL for HPL/HPI (India)

### Dimensional drawing

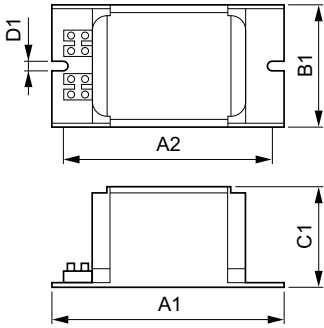

Product	D1	C1	A1	A2	B1
BHL 250 X261	6.3 mm	64.0 mm	132.0 mm	116.0 mm	75.0 mm

BHL 250 X261

