

HID-Basic BHL for HPL/HPI (India)

BHL 400 X261

Impregnated electromagnetic ballasts of copper and steel construction for High-Pressure Mercury Vapor (HPL) lamps

Product data

General Information	
Application Code	400 X261
Lamp Type	HPL/HPI/HPI-T
Number of Lamps	1 piece/unit
Operating and Electrical	
Input Voltage	240 V
Input Frequency	50 Hz
Mains Voltage Performance (AC)	240+6%--8%
Mains Voltage Safety (AC)	240-10%+10%
Input Current with PF Correction	2.10 A
Input Current without PF Correction	3.25 A
Power Factor with PF Compensation	0.85
Power Factor without PF Compensation (Nom)	0.55
Power Losses (Nom)	32 W
Wiring	
Connector Type	Screw
System characteristics	
Rated Ballast-Lamp Power	400 W

Temperature	
T-Winding (Max)	130 °C
Delta-T Normal Conditions	75 °C
Approval and Application	
Energy Efficiency Index	Not specified
Approval Marks	CE marking
Product Data	
Full product code	871150088456500
Order product name	BHL 400 X261
EAN/UPC - Product	8711500884565
Order code	913702253112
Numerator - Quantity Per Pack	1
Numerator - Packs per outer box	4
Material Nr. (12NC)	913702253112
Net Weight (Piece)	2.950 kg

HID-Basic BHL for HPL/HPI (India)

Dimensional drawing

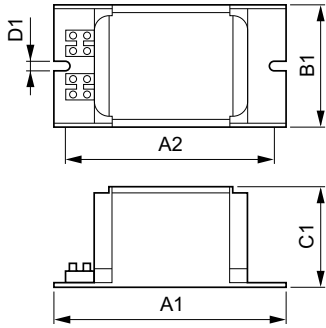

Product	D1	C1	A1	A2	B1
BHL 400 X261	6.3 mm	64.0 mm	150.0 mm	135.0 mm	75.0 mm

BHL 400 X261

