



# Electronic semi-parallel ignitor for HID lamp circuits

## SN 58 T15

HID ignitors for semi-parallel systems

### Product data

Operating and Electrical	
Input Voltage	220 to 240 V
Line Frequency	50 to 60 Hz
Input Frequency	50 to 60 Hz
Wiring	
Connector Type	Screw
Temperature	
Ambient temperature range	-20 °C to 75 °C
T-Case Maximum (Max)	80 °C
Mechanical and Housing	
Housing	Akulon S223

Approval and Application	
Approval Marks	CE marking ENEC certificate
Product Data	
Order product name	SN 58 T15
Full product name	SN 58 T15
Full product code	697013372879600
Order code	913710010413
Material Nr. (12NC)	913710010413
Numerator - Quantity Per Pack	1
EAN/UPC - Product/Case	6970133728796
Numerator - Packs per outer box	48
EAN/UPC - Case	6970133728802

# Electronic semi-parallel ignitor for HID lamp circuits

## Dimensional drawing

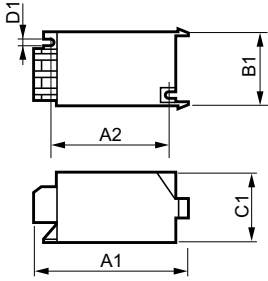

Product	C1	A1	A2	B1
SN 58 T15	38.5 mm	85.5 mm	65.0 mm	41.5 mm

