



Primaline Halogen Transformers

ET-S 15 LED 220-240V

High-Frequency electronic transformer for operation with 12V halogen lamps, available in 70W, 105W and 150W versions

Warnings and Safety

- Transformer is not suitable for DC operation

Product data

| Operating and Electrical | |
|--|-----------------|
| Input Voltage | 220 to 240 V |
| Line Frequency | 50 to 60 Hz |
| Input Frequency | 50 to 60 Hz |
| Inrush Current Width | 0.10 ms |
| Inrush Current Peak (Max) | 15 A |
| Number of Products on MCB (16A Type B) (Nom) | 90 |
| Wiring | |
| Connector Type Input Terminals | Screw |
| Color Input Terminals | Orange |
| Connector Type Output Terminals | Screw |
| Cable Length From Device to Lamp | 1.0 m |
| Temperature | |
| Ambient temperature range | -20 °C to 50 °C |
| T-Case Maximum (Max) | 65 °C |

| Approval and Application | |
|---------------------------------|----------------------|
| Approval Marks | CE marking |
| Product Data | |
| Order product name | ET-S 15 LED 220-240V |
| Full product name | ET-S 15 LED 220-240V |
| Full product code | 871829179717300 |
| Order code | 913710032464 |
| Material Nr. (12NC) | 913710032464 |
| Numerator - Quantity Per Pack | 1 |
| EAN/UPC - Product/Case | 8718291797173 |
| Numerator - Packs per outer box | 50 |
| EAN/UPC - Case | 8718291797180 |

Primaline Halogen Transformers

Dimensional drawing

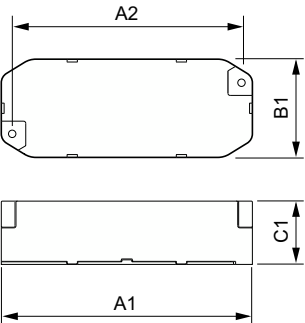

| Product | D1 | C1 | B2 | A1 | A2 | B1 |
|----------------------|--------|---------|-----------|----------|----------|---------|
| ET-S 15 LED 220-240V | 3.4 mm | 29.0 mm | 23.4 inch | 115.0 mm | 105.0 mm | 45.0 mm |

