



HID-Basic ballasts for HPL and HPI(PLUS) lamps

BHL 250L 200

The HID-Basic ballast is an impregnated (HID standard) electromagnetic ballast for HID lamps, for use in combination with an external ignitor.

Product data

Operating and Electrical	
Input Voltage	220 V
Line Frequency	50 Hz
Input Frequency	50 Hz
Wiring	
Connector Type	Screw
Approval and Application	
Approval Marks	CE marking CCC certificate
Product Data	
Order product name	BHL 250L 200

Full product name	BHL 250L 200
Full product code	697480505063500
Order code	913710100442
Material Nr. (12NC)	913710100442
Numerator - Quantity Per Pack	1
EAN/UPC - Product/Case	6974805050635
Numerator - Packs per outer box	6
EAN/UPC - Case	6974805050642

HID-Basic ballasts for HPL and HPI(PLUS) lamps

Dimensional drawing

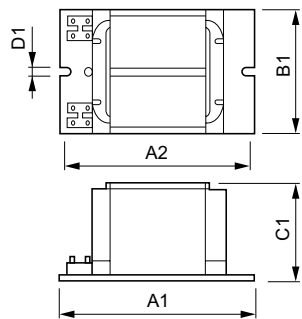

Product	D1	C1	A1	A2	B1
BHL 250L 200	6.2 mm	64.5 mm	125.0 mm	110.0 mm	75.5 mm

