



HID-Basic ballasts for HPL and HPI(PLUS) lamps

BHL 250L 201

The HID-Basic ballast is an impregnated (HID standard) electromagnetic ballast for HID lamps, for use in combination with an external ignitor.

Product data

| Operating and Electrical | |
|--------------------------|--------------|
| Input Voltage | 220 V |
| Line Frequency | 60 Hz |
| Input Frequency | 60 Hz |
| Wiring | |
| Connector Type | Screw |
| Approval and Application | |
| Approval Marks | CE marking |
| Product Data | |
| Order product name | BHL 250L 201 |

| | |
|---------------------------------|-----------------|
| Full product name | BHL 250L 201 |
| Full product code | 871016303468330 |
| Order code | 913710101850 |
| Material Nr. (12NC) | 913710101850 |
| Numerator - Quantity Per Pack | 1 |
| EAN/UPC - Product/Case | 8710163034683 |
| Numerator - Packs per outer box | 6 |
| EAN/UPC - Case | 8710163034782 |

HID-Basic ballasts for HPL and HPI(PLUS) lamps

Dimensional drawing

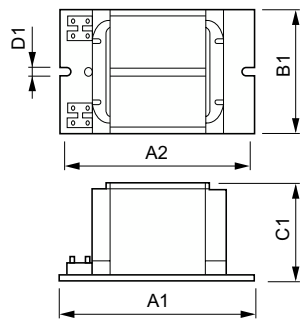

| Product | D1 | C1 | A1 | A2 | B1 |
|--------------|--------|---------|----------|----------|---------|
| BHL 250L 201 | 6.2 mm | 64.5 mm | 125.0 mm | 110.0 mm | 75.5 mm |

