

HID-Basic ballasts for HPL and HPI(PLUS) lamps

BHL 400L 202

The HID-Basic ballast is an impregnated (HID standard) electromagnetic ballast for HID lamps, for use in combination with an external ignitor.

Product data

General Information		Temperature	
Application Code	L202	T-Winding (Max)	130 °C
		Delta-T Normal Conditions	75 °C
Operating and Electrical		Approval and Application	
Input Voltage	230 V	Approval Marks	CE marking
Input Frequency	50 Hz		
Power Factor 100% Load (Min)	0.6	Product Data	
Mains Voltage Performance (AC)	-8% - +6%	Full product code	871016303127930
Mains Voltage Safety (AC)	-10% - +10%	Order product name	BHL 400L 202
Input Current with PF Correction	2.15 A	EAN/UPC - Product	8710163148328
Power Factor without PF Compensation (Nom)	0.85	Order code	913710102650
Power Losses (Nom)	24.4 W	Numerator - Quantity Per Pack	1
Wiring		Numerator - Packs per outer box	6
Connector Type	Screw	Material Nr. (12NC)	913710102650
		Net Weight (Piece)	2.833 kg
System characteristics			
Rated Ballast-Lamp Power	400 W		

HID-Basic ballasts for HPL and HPI(PLUS) lamps

Dimensional drawing

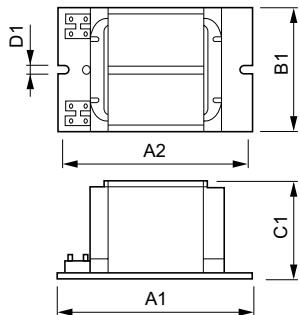

Product	D1	C1	A1	A2	B1
BHL 400L 202	6.3 mm	64.5 mm	150.0 mm	134.0 mm	75.5 mm

BHL 400 L202

