

HID-Basic Semi-Parallel ballasts for MHN/CDM lamps

BMH 70L 302I TS

The HID Basic Semi-Parallel ballast is an impregnated (HID standard) electromagnetic copper/iron ballast for use with an external ignitor for metal-halide and CDM lamps.

Product data

Operating and Electrical		Full product name		BMH 70L 302I TS	
Input Voltage	230 V	Full product code		871016303140830	
Line Frequency	50 Hz	Order code		913710103250	
Input Frequency	50 Hz	Material Nr. (12NC)		913710103250	
		Numerator - Quantity Per Pack		1	
		EAN/UPC - Product/Case		8710163148434	
		Numerator - Packs per outer box		6	
		EAN/UPC - Case		8710163032399	
Approval and Application					
Approval Marks		CE marking CCC certificate			
Product Data					
Order product name		BMH 70L 302I TS			

HID-Basic Semi-Parallel ballasts for MHN/CDM lamps

Dimensional drawing

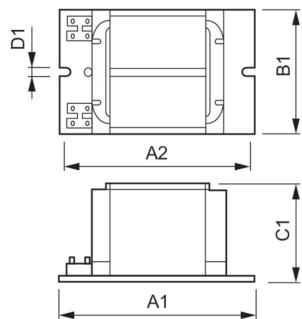

Product	D1	C1	A1	A2	B1
BMH 70L 302I TS	6.2 mm	51.5 mm	117.0 mm	102.0 mm	57.1 mm

