



HID-High Power ballasts for MH lamps

BMH 1800L 202

The HID High-Power ballast is an impregnated (HID standard) electromagnetic copper/iron ballast for use with an external ignitor for HID lamps.

Product data

General Information	
Application code	L202
Operating and Electrical	
Input voltage	230 V
Input frequency	50 Hz
Power factor 100% load (min.)	0.85
Mains voltage performance (AC)	-8% - +6%
Mains voltage safety (AC)	-10% - +10%
Input current with PF correction	8.6 A
Input current without PF Correction	17.3 A
Power factor without PF compensation (max.)	0.50
Power factor without PF compensation (min.)	0.40
Power losses (nom.)	75 W
Wiring	
Connector type	Screw
System characteristics	
Rated ballast-lamp power	1800 W

Temperature	
T winding (max.)	130 °C
Delta-T normal conditions	85 °C
Approval and Application	
Approval marks	CCC certificate
Product Data	
Full product code	694818229962800
Order product name	BMH 1800L 202
EAN/UPC – product	6948182295422
Order code	913710107142
Numerator – quantity per pack	1
Numerator – packs per outer box	1
Material no. (12NC)	913710107142
Net weight (piece)	13.500 kg

HID-High Power ballasts for MH lamps

Dimensional drawing

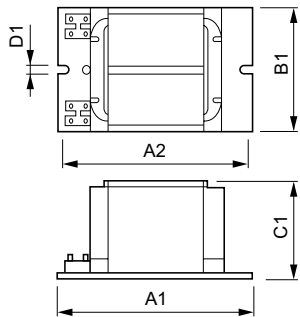

Product	D1	C1	A1	A2	B1
BMH 1800L 202	7 mm	102.0 mm	234 mm	185.5 mm	120.0 mm

BMH 1800 L202

