



# HID-High Power ballasts for MH lamps

## BMH 2000L 2050

The HID High-Power ballast is an impregnated (HID standard) electromagnetic copper/iron ballast for use with an external ignitor for HID lamps.

### Product data

<b>Operating and Electrical</b>	
Input Voltage	400 V
Line Frequency	50 Hz
Input Frequency	50 Hz
<b>Wiring</b>	
Connector Type	Screw
<b>Approval and Application</b>	
Approval Marks	CCC certificate
<b>Product Data</b>	
Order product name	BMH 2000L 2050

Full product name	BMH 2000L 2050
Full product code	697480505087100
Order code	913710107242
Material Nr. (12NC)	913710107242
Numerator - Quantity Per Pack	1
EAN/UPC - Product/Case	6974805050871
Numerator - Packs per outer box	1
EAN/UPC - Case	6974805050888

# HID-High Power ballasts for MH lamps

## Dimensional drawing

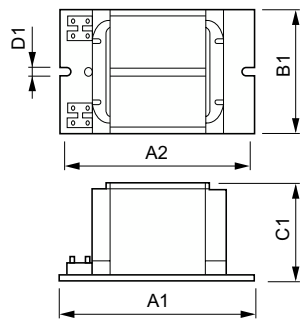

Product	D1	C1	A1	A2	B1
BMH 2000L 2050	7 mm	102.0 mm	234 mm	185.5 mm	120.0 mm

