

ROVR

ROVR ELE DIM BAL (2) 26W CFL (4-PIN) 120-277V

Philips Advance ROVR ballasts reflect the latest approach to controlling fluorescent lighting. Rather than simply responding to instructions from control components, ROVR ballasts enable twoway communication, and have the ability to dim and switch individual ballasts through the control signal. These features allow for virtually unlimited design flexibility while creating sustainable lighting systems. This two-way communication is made possible through the industry-standard digital communication protocol known as DALI (Digital Addressable Lighting Interface). This protocol allows ROVR ballasts to provide users with operational data while controlling the output of individual luminaires. This fully supports sustainable design principles such as daylight harvesting and occupancy sensors while enabling a proactive response to maintenance concerns.

Product data

General Information	
Lamp Type	CFQ26W/G24Q
Number of Lamps	1/2 piece/unit
Ballast Type	Dimmable Fluorescent
Base Model	IDL2S26M5BS
Suitable For Outdoor Use	Yes
Automatic Restart	Yes

Operating and Electrical	
Input Voltage	120 to 277 V
Input Frequency	50 to 60 Hz
Max THD	10 %
Starting Method	Programmed Start
Lamp Current Crest Factor (Nom)	1.6
Ignition Time (Nom)	1.5 s
Ballast Factor (Max)	1

Ballast Factor (Min)	0.03
Power Factor (Nom)	0.99
Input Current (Operating) (Max)	0.46 A
Input Current (Operating) (Min)	0.20 A
Input Power (Max)	55 W
Input Power (Min)	13 W
Rated Lamp Watts	26 W

Wiring	
Color Input Terminals	BLK, WHT & PUR
Color Output Terminals	RED, YEL & BLU
Wire Striplength	0.375 mm
Control Wire Gauge	18AWG
Lamp Connection	Series
Wire Length by Color	No wires
Wire Gauge (Nom)	18AWG mm

Wire Type	Solid
Remote Wiring Configuration Allowed	No
Tandem Wiring Configuration Allowed	No
Through Wiring Configuration Allowed	No
Max Ballast-Lamp Distance Remote Wiring	No Remote
Max Ballast-Lamp Distance Tandem Wiring	No Tandem
Max Ballast-Lamp Distance Through Wiring	No Through
Connector Type	Poke-In

Temperature

T-Case Maximum (Nom)	70 °C
----------------------	-------

Mechanical and Housing

Housing Material	Metal
Housing	M5
Housing Dimensions	4.98" x 3.0" x 1.18"

Approval and Application

EMC Immunity Standard	FCC Consumer
-----------------------	--------------

Approbation Marks	CSA certificate UL certificate CEC Listing RoHS Compliant
Sound Rating	A
UL Recognized	No

Product Data

Order product name	ROVR ELE DIM BAL (2) 26W CFL (4-PIN) 120-277V
EAN/UPC - Product	781087032770
Order code	IDL2S26M5BS35M
Numerator - Quantity Per Pack	1
Numerator - Packs per outer box	16
Material Nr. (12NC)	913710212602
Net Weight (Piece)	0.350 kg

Dimensional drawing

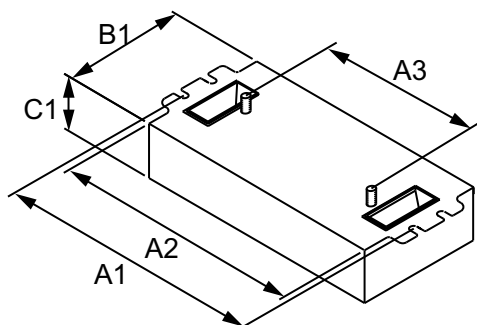

ELE DIM BAL (2) 26W CFL (4-PIN) 120-277V

Product	A1	A2	A3	B1	C1
ROVR ELE DIM BAL (2) 26W CFL (4-PIN) 120-277V	4.55 in	4.20 in	2.00 in	3.00 in	1.18 in

