



AmbiStar

AMBISTAR ELE BALLAST (2) 26W CFL (4-PIN) 120V

Ambistar electronic ballasts are an easy-to-install, energy-efficient replacement solution for optimizing residential and hospitality lighting.

Product data

General Information		Wire Striplength	
Lamp Type	CFQ26W/G24Q	Wire Striplength	0.375 mm
Number of Lamps	1/2 piece/unit	Lamp Connection	Series
Ballast Type	Electronic Fluorescent	Wire Length by Color	No wires
Base Model	RCF2S26H1LDQS	Wire Gauge (Nom)	18AWG mm
Suitable For Outdoor Use	Yes	Wire Type	Solid
Automatic Restart	Yes	Remote Wiring Configuration Allowed	Yes
Operating and Electrical		Tandem Wiring Configuration Allowed	Yes
Input Voltage	120 V	Through Wiring Configuration Allowed	Yes
Input Frequency	60 Hz	Max Ballast-Lamp Distance Remote Wiring	1-L = 15' / 2-L = 6'
Total Harmonic Distortion USA	10 %	Max Ballast-Lamp Distance Tandem Wiring	2-L: Red = 6'
Ignition Method	Rapid Start	Max Ballast-Lamp Distance Through Wiring	2-L: Red = 6'
Crestfactor (Nom)	1.7	Connector Type	Poke-In
Ignition Time (Nom)	1 s	Temperature	
Ballast Factor (Nom)	1	T-Case Maximum (Nom)	85 °C
Power Factor (Nom)	0.98	Mechanical and Housing	
Input Current (Nom)	0.43 A	Housing Material	Metal-Plastic
Input Power (Nom)	51 W	Housing	H1
Rated Lamp Power	26 W	Housing Dimensions	4.98" x 2.4" x 0.98"
Wiring		Approval and Application	
Color Input Terminals	Black and White	EMC Immunity Standard	FCC Consumer
Color Output Terminals	RED, YEL & BLU		

Approval Marks	CSA certificate UL certificate CEC Listing Energy Star RoHS Compliant
Hum And Noise Level	A
UL Recognized	No
Product Data	
Order product name	AMBISTAR ELE BALLAST (2) 26W CFL (4-PIN) 120V

EAN/UPC - Product	781087027431
Order code	913710214702
Numerator - Quantity Per Pack	1
Numerator - Packs per outer box	20
Material Nr. (12NC)	913710214702
Net Weight (Piece)	159.000 g

Dimensional drawing

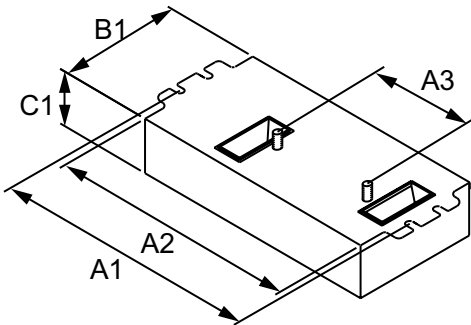

Product	A1	A2	A3	B1	C1
AMBISTAR RCF2S26H1LDQS35M	4.60 in	4.20 in	2.00 in	2.40 in	0.98 in

ELE BALLAST (2) 26W CFL (4-PIN) 120V

