



# AmbiStar

## AMBISTAR ELE BALLAST (2) 13W CFL (4-PIN) 120V

Ambistar electronic ballasts are an easy-to-install, energy-efficient replacement solution for optimizing residential and hospitality lighting.

### Product data

<b>General Information</b>		<b>Wire Striplength</b>	
Lamp Type	CFQ13W/G24Q	Lamp Connection	Series
Number of Lamps	1/2 piece/unit	Wire Length by Color	No wires
Ballast Type	Electronic Fluorescent	Wire Gauge (Nom)	18AWG mm
Base Model	RCF2S13M1BSQS	Wire Type	Solid
Suitable For Outdoor Use	Yes	Remote Wiring Configuration Allowed	Yes
Automatic Restart	Yes	Tandem Wiring Configuration Allowed	Yes
<b>Operating and Electrical</b>		Through Wiring Configuration Allowed	Yes
Input Voltage	120 V	Max Ballast-Lamp Distance Remote	1-L = 15' / 2-L = 6'
Input Frequency	60 Hz	Wiring	
Max THD	10 %	Max Ballast-Lamp Distance Tandem	2-L: Red = 6'
Starting Method	Rapid Start	Wiring	
Lamp Current Crest Factor (Nom)	1.7	Max Ballast-Lamp Distance Through	2-L: Red = 6'
Ignition Time (Nom)	1 s	Wiring	
Ballast Factor (Nom)	1	Connector Type	Poke-In
Power Factor (Nom)	0.98	<b>Temperature</b>	
Input Current (Operating) (Nom)	0.25 A	T-Case Maximum (Nom)	85 °C
Input Power (Nom)	29 W	<b>Mechanical and Housing</b>	
Rated Lamp Watts	13 W	Housing Material	Metal
<b>Wiring</b>		Housing	M1
Color Input Terminals	BLK & WHT	Housing Dimensions	4.98" x 2.4" x 0.98"
Color Output Terminals	RED, YEL & BLU		

Approval and Application	
EMC Immunity Standard	FCC Consumer
Approbation Marks	CSA certificate UL certificate CEC Listing Energy Star RoHS Compliant
Sound Rating	A
UL Recognized	No

Product Data	
Order product name	AMBISTAR ELE BALLAST (2) 13W CFL (4-PIN) 120V

EAN/UPC - Product	781087043561
Order code	RCF2S13M1BSQS35M
Numerator - Quantity Per Pack	1
Numerator - Packs per outer box	16
Material Nr. (12NC)	913710261502
Net Weight (Piece)	196.000 g

Dimensional drawing

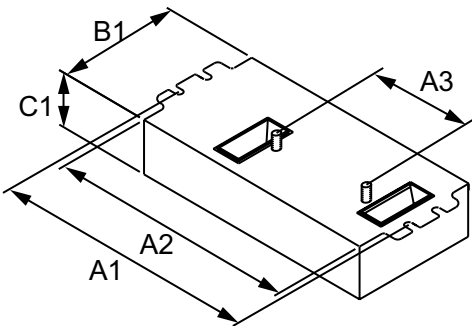

ELE BALLAST (2) 13W CFL (4-PIN) 120V

Product	A1	A2	A3	B1	C1
AMBISTAR RCF2S13M1BSQS35M	4.60 in	4.20 in	2.00 in	3.00 in	1.29 in

