



# AmbiStar

## AMBISTAR ELE BALLAST (2) 18W CFL (4-PIN) 120V

Ambistar electronic ballasts are an easy-to-install, energy-efficient replacement solution for optimizing residential and hospitality lighting.

### Product data

General Information			
Lamp Type	CFQ18W/G24Q	Wire Striplength	0.375 mm
Number of Lamps	1/2 piece/unit	Lamp Connection	Series
Ballast Type	Electronic Fluorescent	Wire Length by Color	No wires
Base Model	RCF2S18M1BSQS	Wire Gauge (Nom)	18AWG mm
Suitable For Outdoor Use	Yes	Wire Type	Solid
Automatic Restart	Yes	Remote Wiring Configuration Allowed	Yes
		Tandem Wiring Configuration Allowed	Yes
		Through Wiring Configuration Allowed	Yes
		Max Ballast-Lamp Distance Remote Wiring	1-L = 15' / 2-L = 6'
		Max Ballast-Lamp Distance Tandem Wiring	2-L: Red = 6'
		Max Ballast-Lamp Distance Through Wiring	2-L: Red = 6'
		Connector Type	Poke-In
Operating and Electrical		Temperature	
Input Voltage	120 V	T-Case Maximum (Nom)	85 °C
Input Frequency	60 Hz		
Total Harmonic Distortion USA	10 %	Mechanical and Housing	
Ignition Method	Rapid Start	Housing Material	Metal
Crestfactor (Nom)	1.7	Housing	M1
Ignition Time (Nom)	1 s	Housing Dimensions	4.98" x 2.4" x 0.98"
Ballast Factor (Nom)	0.95		
Power Factor (Nom)	0.98	Approval and Application	
Input Current (Nom)	0.3 A	EMC Immunity Standard	FCC Consumer
Input Power (Nom)	35 W		
Rated Lamp Power	18 W		
Wiring			
Color Input Terminals	BLK & WHT		
Color Output Terminals	RED, YEL & BLU		

Approval Marks	CSA certificate UL certificate CEC Listing
	Energy Star RoHS Compliant
Hum And Noise Level	A
UL Recognized	No
Product Data	
Order product name	AMBISTAR ELE BALLAST (2) 18W CFL (4-PIN) 120V
EAN/UPC - Product	781087043554

Order code	517870
Local order code	517870
Numerator - Quantity Per Pack	1
Numerator - Packs per outer box	16
Material Nr. (12NC)	913710261602
Net Weight (Piece)	196.000 g

Dimensional drawing

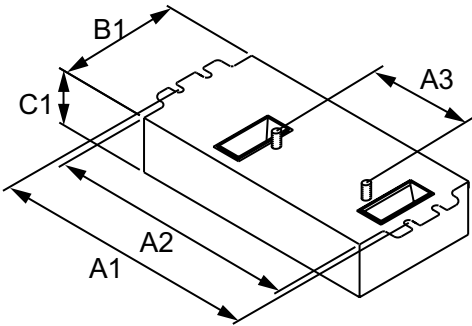

ELE BALLAST (2) 18W CFL (4-PIN) 120V

Product	A1	A2	A3	B1	C1
AMBISTAR RCF2S18M1BSQS35M	4.60 in	4.20 in	2.00 in	3.00 in	1.29 in

