



Core & Coil (71A) MH ~GT~ 450W

CORE & COIL HID MH BAL 1000W M47 QUAD C&C

The basic ballast is the open core and coil which is most often used as a component within a lighting luminaire. The core and coil also forms the nucleus of Philips Advance's five other ballast configurations.

Product data

General Information			
ANSI Code	M47	Constant Wattage Deviation	10%
Circuit Type	CWA	Ballast Factor (Nom)	1.00
Ballast Type	Magnetic HID	Nominal Open Circuit Voltage	415 V
Base Model	71A6590	Input Current (Operating) (Nom)	9/5.2/4.5/3.9 A A
Core Size	4 1/4 x 4 3/4 (2 coil)	Input Power (Nom)	1070 W
Suitable For Outdoor Use	Yes	Rated Lamp Watts	1000 W
Ignitor Catalog Number	NA	Wiring	
Ignitor Temperature Rating	NA	Wire Striplength	0.5 mm
Capacitor Catalog Number	MD2409000	Wire Length by Color	12"
Capacitor Requirements	480V	Wire Type	Stranded
Capacitor Temperature Rating	90°C	Remote Wiring Configuration Allowed	Yes
Capacitor Diameter/Oval Dimensions	1.75 in	Max Ballast-Lamp Distance Remote	Determined by AWG used
Capacitor Height	3.9 in	Wiring	
Automatic Restart	No	Recommended Fuse Value	20/15/10/10 A
Operating and Electrical		Approval and Application	
Inp. Current (Open Circuit)	5/2.7/2.5/2.2 A	Open Circuit Voltage Test (Volts)	370-460 V
Input Current (Starting)	7/4/3.5/3 A	Approbation Marks	ULR CSA certificate RoHS Compliant
Input Current (Short Circuit)	5.3-8/3.1-4.7/2.65-4/2.3-3.5 V	Temperature Marking	D/D/D/D
Secondary Short Circuit Current	4.9-6.1 A	UL Recognized	Yes

Core & Coil (71A) MH ~GT~ 450W

Hipot Test (1 Minute)	2000 V
Hipot Test (2 Seconds)	2500 V
UL Insulation Class	H(180°C)
UL Temperature Code	1029D
Product Data	
Order product name	CORE & COIL HID MH BAL 1000W M47 QUAD C&C

EAN/UPC - Product	781087026397
Order code	71A6590500
Numerator - Quantity Per Pack	1
Numerator - Packs per outer box	2
Material Nr. (12NC)	913710417002
Net Weight (Piece)	9.050 kg

Dimensional drawing

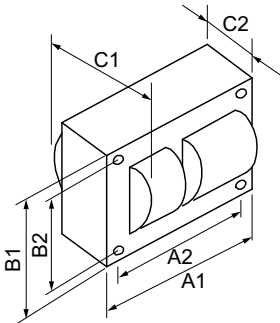

MH BAL 1000W M47 QUAD C&C

Product	C1	C2	A1	A2	B1	B2
CORE & COIL HID MH BAL 1000W M47 QUAD C&C	5.25 in	3.32 in	4.8 in	4.4 in	4.3 in	3.9 in

