



# Core & Coil (71A) MH ~GT~ 450W

## CORE & COIL HID MH BAL 1000W M47 QUAD C&C

The basic ballast is the open core and coil which is most often used as a component within a lighting luminaire. The core and coil also forms the nucleus of Philips Advance's five other ballast configurations.

### Product data

General Information		Constant Wattage Deviation	
ANSI Code	M47	Ballast Factor (Nom)	1.00
Circuit Type	CWA	Open Circuit Voltage	415 V
Ballast Type	Magnetic HID	Input Current (Nom)	9/5.2/4.5/3.9 A A
Base Model	71A6590	Input Power (Nom)	1070 W
Core Size	4 1/4 x 4 3/4 (2 coil)	Rated Lamp Power	1000 W
Suitable For Outdoor Use	Yes	Wiring	
Ignitor Catalog Number	NA	Wire Striplength	0.5 mm
Ignitor Temperature Rating	NA	Wire Length by Color	12"
Capacitor Catalog Number	MD2409000	Wire Type	Stranded
Capacitor Requirements	480V	Remote Wiring Configuration Allowed	Yes
Capacitor Temperature Rating	90°C	Max Ballast-Lamp Distance Remote	Determined by AWG used
Capacitor Diameter/Oval Dimensions	1.75 in	Wiring	
Capacitor Height	3.9 in	Recommended Fuse Value	20/15/10/10 A
Automatic Restart	No	Approval and Application	
Operating and Electrical		Open Circuit Voltage Test (Volts)	370-460 V
Input Current (Open Circuit)	5/2.7/2.5/2.2 A	Approval Marks	ULR CSA certificate RoHS Compliant
Input Current (Starting)	7/4/3.5/3 A	Temperature Marking	D/D/D/D
Input Current (Short Circuit)	5.3-8/3.1-4.7/2.65-4/2.3-3.5 V	UL Recognized	Yes
Secondary Short Circuit Current	4.9-6.1 A		

Core & Coil (71A) MH ~GT~ 450W

Hipot Test (1 Minute)	2000 V
Hipot Test (2 Seconds)	2500 V
UL Insulation Class	H(180°C)
UL Temperature Code	1029D
Product Data	
Order product name	CORE & COIL HID MH BAL 1000W M47 QUAD C&C

EAN/UPC - Product	781087026397
Order code	913710417002
Numerator - Quantity Per Pack	1
Numerator - Packs per outer box	2
Material Nr. (12NC)	913710417002
Net Weight (Piece)	9.050 kg

Dimensional drawing

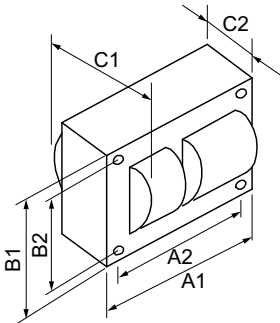

MH BAL 1000W M47 QUAD C&C

Product	C1	C2	A1	A2	B1	B2
CORE & COIL HID MH BAL 1000W M47 QUAD C&C	5.25 in	3.32 in	4.8 in	4.4 in	4.3 in	3.9 in

