



Core & Coil (71A) MH ~LT~ 175W

**CORE & COIL HID MH BAL 150W M102/142
120/220/240V 50 HZ**

The basic ballast is the open core and coil which is most often used as a component within a lighting luminaire. The core and coil also forms the nucleus of Philips Advance's five other ballast configurations.

Product data

General Information	
ANSI Code	M102- M142
Lamp Type	150 MH
Number of Lamps	1 piece/unit
Circuit Type	HX-HPF
Ballast Type	Magnetic HID
Base Model	71A54N2
Core Size	3 X 4 (2 coil)
Suitable For Outdoor Use	Yes
Ignitor Catalog Number	LI533-H4
Ignitor Temperature Rating	105°C
Capacitor Value	28 MFD
Capacitor Catalog Number	7C280P30RA
Capacitor Requirements	240V
Capacitor Temperature Rating	105°C
Capacitor Diameter/Oval Dimensions	1.85 in
Capacitor Height	3.7 in
Automatic Restart	No

Operating and Electrical	
Input Voltage	120/220/240 V
Input Frequency	50 Hz
Inp. Current (Open Circuit)	3.7/2/1.8 A
Input Current (Starting)	2/1.15/1 A
Input Current (Short Circuit)	0.85-1.26/0.46-0.68/0.42-0.64 A
Secondary Short Circuit Current	1.6-2.05 A
Constant Wattage Deviation	14%
Ballast Factor (Nom)	1
Power Factor (Nom)	0.90
Nominal Open Circuit Voltage	248 V
Input Current (Operating) (Nom)	1.7/0.95/0.85 A A
Input Power (Nom)	187 W
Rated Lamp Watts	150 W
Wiring	
Wire Striplength	0.5 mm
Wire Length by Color	12"
Wire Type	Stranded
Remote Wiring Configuration Allowed	Yes

Core & Coil (71A) MH ~LT~ 175W

Max Ballast-Lamp Distance Remote	5'
Wiring	
Recommended Fuse Value	10/5/5 A
Approval and Application	
Open Circuit Voltage Test (Volts)	228-279 V
Approbation Marks	RoHS Compliant CSA certificate
Temperature Marking	C/C/D
UL Recognized	Yes
Hipot Test (1 Minute)	1500 V
Hipot Test (2 Seconds)	2500 V
UL Insulation Class	H(180°C)
UL Temperature Code	1029D

Product Data	
Order product name	CORE & COIL HID MH BAL 150W M102/142 120/220/240V 50 HZ
EAN/UPC - Product	781087118405
Order code	71A54N2500D
Numerator - Quantity Per Pack	1
Numerator - Packs per outer box	4
Material Nr. (12NC)	913710420102
Net Weight (Piece)	3.797 kg

Dimensional drawing

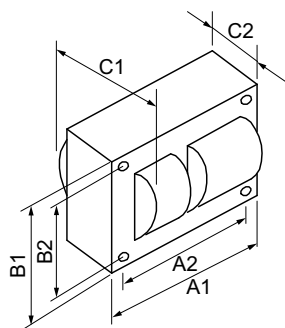

Product	C1	C2	A1	A2	B1	B2
CORE & COIL HID 71A54N2500D	4.1 in	2.5 in	3.9 in	3.5 in	2.8 in	2.4 in

MH BAL M102/142 120/220/240V 50 HZ C&C

