



Core & Coil (71A) MH 175W – 450W

CORE & COIL HID MH BAL 320W M132/154 120/220-240V 50HZ

The basic ballast is the open core and coil which is most often used as a component within a lighting luminaire. The core and coil also forms the nucleus of Philips Advance's five other ballast configurations.

Product data

General Information		Operating and Electrical	
ANSI Code	M132-M154	Input Voltage	120/220-240 V
Lamp Type	320W MH	Input Frequency	50 Hz
Number of Lamps	1 piece/unit	Input Current (Open Circuit)	1.9/1 A
Circuit Type	SUPER-CWA	Input Current (Starting)	2.28/1.14 A
Ballast Type	Magnetic HID	Input Current (Short Circuit)	3.7-5.5/1.9-2.9 A
Base Model	71A58N2	Secondary Short Circuit Current	4.8-5.57 A
Core Size	4 1/4 x 4 3/4 (2 coil)	Constant Wattage Deviation	10%
Suitable For Outdoor Use	Yes	Ballast Factor (Nom)	1
Ignitor Catalog Number	LI533-H4	Power Factor (Nom)	0.90
Ignitor Temperature Rating	105°C	Open Circuit Voltage	280 V
Capacitor Value	24 MFD	Input Current (Nom)	3.05/1.6 A A
Capacitor Catalog Number	7C240P40R	Input Power (Nom)	365 W
Capacitor Requirements	400V	Rated Lamp Power	320 W
Capacitor Temperature Rating	105°C		
Capacitor Diameter/Oval Dimensions	1.75 in	Wiring	
Capacitor Height	4.8 in	Wire Striplength	0.5 mm
Automatic Restart	No	Wire Length by Color	12"
		Wire Type	Stranded
		Remote Wiring Configuration Allowed	Yes

Core & Coil (71A) MH 175W - 450W

Max Ballast-Lamp Distance Remote Wiring 2'	
Recommended Fuse Value	10/5 A
Approval and Application	
Open Circuit Voltage Test (Volts)	275-320 V
Approval Marks	ULR CSA certificate RoHS Compliant
Temperature Marking	A/A
UL Recognized	Yes
Hipot Test (1 Minute)	2000 V
Hipot Test (2 Seconds)	2500 V
UL Insulation Class	H(180°C)
UL Temperature Code	1029A

Product Data	
Order product name	CORE & COIL HID MH BAL 320W M132/154 120/220-240V 50HZ
EAN/UPC - Product	781087098660
Order code	913710421602
Numerator - Quantity Per Pack	1
Numerator - Packs per outer box	4
Material Nr. (12NC)	913710421602
Net Weight (Piece)	5.884 kg

Dimensional drawing

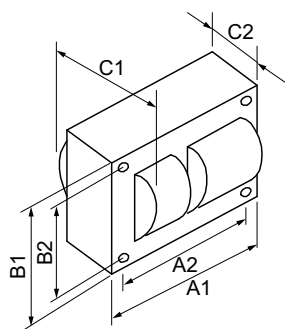

Product	C1	C2	A1	A2	B1	B2
CORE & COIL HID 71A58N2500D	3.8 in	2.05 in	4.8 in	4.4 in	4.3 in	3.9 in

MH BAL 320W M132/154 120/220-240V 50HZ

