



Core & Coil (71A) MH ~LT~ 175W

CORE & COIL HID MH BAL 70W M85 120/277V C&C

The basic ballast is the open core and coil which is most often used as a component within a lighting luminaire. The core and coil also forms the nucleus of Philips Advance's five other ballast configurations.

Product data

General Information	
ANSI Code	M85
Lamp Type	70W MH
Number of Lamps	1 piece/unit
Circuit Type	HX-HPF
Ballast Type	Magnetic HID
Base Model	71A5280
Core Size	3 X 4 (2 coil)
Suitable For Outdoor Use	Yes
Ignitor Catalog Number	LI522-H5
Ignitor Temperature Rating	105°C
Capacitor Value	8 MFD
Capacitor Catalog Number	7C080L30RA
Capacitor Requirements	280V
Capacitor Temperature Rating	105°C
Capacitor Diameter/Oval Dimensions	1.25 in
Capacitor Height	2.75 in
Automatic Restart	No

Operating and Electrical	
Input Voltage	120/277 V
Input Frequency	60 Hz
Inp. Current (Open Circuit)	1.6/0.7 A
Input Current (Starting)	0.85/0.4 A
Input Current (Short Circuit)	0.7-1.1/0.3-0.5 A
Secondary Short Circuit Current	1.1-1.4 A
Constant Wattage Deviation	7%
Ballast Factor (Nom)	1
Power Factor (Nom)	0.90
Nominal Open Circuit Voltage	245 V
Input Current (Operating) (Nom)	0.85/0.37 A A
Input Power (Nom)	94 W
Rated Lamp Watts	70 W

Wiring	
Wire Striplength	0.5 mm
Wire Length by Color	12"
Wire Type	Stranded
Remote Wiring Configuration Allowed	Yes

Core & Coil (71A) MH ~LT~ 175W

Max Ballast-Lamp Distance Remote Wiring	20'
Recommended Fuse Value	4/2 A
Approval and Application	
Open Circuit Voltage Test (Volts)	220-270 V
Approbation Marks	ULR CSA certificate RoHS Compliant
Temperature Marking	A/A
UL Recognized	Yes
Hipot Test (1 Minute)	2000 V
Hipot Test (2 Seconds)	2500 V
UL Insulation Class	H(180°C)
UL Temperature Code	1029A

Product Data	
Order product name	CORE & COIL HID 71A5280510D
EAN/UPC - Product	781087017043
Order code	71A5280510D
Numerator - Quantity Per Pack	1
Numerator - Packs per outer box	4
Material Nr. (12NC)	913710462702
Net Weight (Piece)	2.219 kg

Dimensional drawing

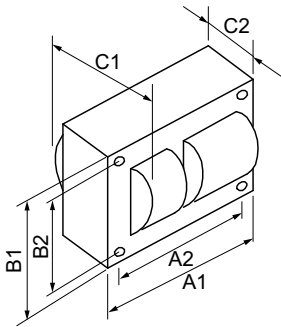

MH BAL 70W M85 120/277V C&C

Product	C1	C2	A1	A2	B1	B2
CORE & COIL HID 71A5280510D	2.7 in	1.5 in	3.9 in	3.5 in	2.8 in	2.4 in

