

Core & Coil (71A) MH ~LT~ 175W

**CORE & COIL HID MH BAL 70W M98/143 127/220V
C&C**

The basic ballast is the open core and coil which is most often used as a component within a lighting luminaire. The core and coil also forms the nucleus of Philips Advance's five other ballast configurations.

Product data

General Information	
ANSI Code	M98-M143
Lamp Type	70W MH
Number of Lamps	1 piece/unit
Circuit Type	HX-HPF
Ballast Type	Magnetic HID
Base Model	71A52H2
Core Size	3 X 4 (2 coil)
Suitable For Outdoor Use	Yes
Ignitor Catalog Number	LI534-H5
Ignitor Temperature Rating	105°C
Capacitor Value	8 MFD
Capacitor Catalog Number	7C080L30RA
Capacitor Requirements	280V
Capacitor Temperature Rating	105°C
Capacitor Diameter/Oval Dimensions	1.25 in
Capacitor Height	2.75 in
Automatic Restart	No

Operating and Electrical	
Input Voltage	127/220 V
Input Frequency	60 Hz
Input Current (Open Circuit)	1.9/0.85 A
Input Current (Starting)	0.5/0.35 A
Input Current (Short Circuit)	0.55-0.8/0.3-0.5 A
Secondary Short Circuit Current	0.95-1.25 A
Constant Wattage Deviation	10%
Ballast Factor (Nom)	1
Power Factor (Nom)	0.90
Open Circuit Voltage	255 V
Input Current (Nom)	0.82/0.48 A A
Input Power (Nom)	94 W
Rated Lamp Power	70 W
Wiring	
Wire Striplength	0.5 mm
Wire Length by Color	12"
Wire Type	Stranded
Remote Wiring Configuration Allowed	Yes

Core & Coil (71A) MH ~LT~ 175W

Max Ballast-Lamp Distance Remote Wiring	15'
Recommended Fuse Value	4/2 A
Approval and Application	
Open Circuit Voltage Test (Volts)	230-280 V
Approval Marks	NOM certificate RoHS Compliant CSA certificate
Temperature Marking	A/A
UL Recognized	Yes
Hipot Test (1 Minute)	2000 V
Hipot Test (2 Seconds)	2500 V
UL Insulation Class	H(180°C)
UL Temperature Code	1029A

Product Data	
Order product name	CORE & COIL HID MH BAL 70W M98/143 127/220V C&C
EAN/UPC - Product	781087034736
Order code	913710486802
Numerator - Quantity Per Pack	1
Numerator - Packs per outer box	2
Material Nr. (12NC)	913710486802
Net Weight (Piece)	2.482 kg

Dimensional drawing

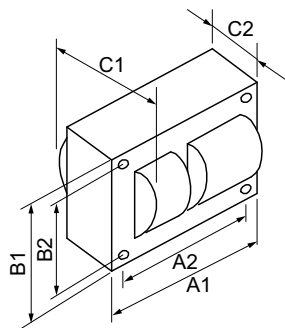

MH BAL 70W M98/143 127/220V C&C

Product	C1	C2	A1	A2	B1	B2
CORE & COIL HID 71A52H2500DML	2.75 in	1.45 in	3.9 in	3.5 in	2.8 in	2.4 in

