

# Core & Coil (71A) MH ~LT~ 175W

## CORE & COIL HID MH BAL 100W M90/140 127/220V C&C

The basic ballast is the open core and coil which is most often used as a component within a lighting luminaire. The core and coil also forms the nucleus of Philips Advance's five other ballast configurations.

### Product data

| General Information                |                |
|------------------------------------|----------------|
| ANSI Code                          | M90-M140       |
| Lamp Type                          | 100 MH         |
| Number of Lamps                    | 1 piece/unit   |
| Circuit Type                       | HX-HPF         |
| Ballast Type                       | Magnetic HID   |
| Base Model                         | 71A53H0        |
| Core Size                          | 3 X 4 (2 coil) |
| Suitable For Outdoor Use           | Yes            |
| Ignitor Catalog Number             | LI533-H4       |
| Ignitor Temperature Rating         | 105°C          |
| Capacitor Value                    | 12 MFD         |
| Capacitor Catalog Number           | 7C120M30RA     |
| Capacitor Requirements             | 280V           |
| Capacitor Temperature Rating       | 105°C          |
| Capacitor Diameter/Oval Dimensions | 1.65 in        |
| Capacitor Height                   | 2.75 in        |
| Automatic Restart                  | No             |

| Operating and Electrical        |                       |
|---------------------------------|-----------------------|
| Input Voltage                   | 127/220 V             |
| Input Frequency                 | 60 Hz                 |
| Input Current (Open Circuit)    | 2.2/1.3 A             |
| Input Current (Starting)        | 1.25/0.9 A            |
| Input Current (Short Circuit)   | 0.75-1.15/0.35-0.65 A |
| Secondary Short Circuit Current | 1.3-1.6 A             |
| Constant Wattage Deviation      | 12%                   |
| Ballast Factor (Nom)            | 1                     |
| Power Factor (Nom)              | 0.90                  |
| Open Circuit Voltage            | 280 V                 |
| Input Current (Nom)             | 1/0.64 A A            |
| Input Power (Nom)               | 129 W                 |
| Rated Lamp Power                | 100 W                 |

| Wiring                              |          |
|-------------------------------------|----------|
| Wire Striplength                    | 0.5 mm   |
| Wire Length by Color                | 12"      |
| Wire Type                           | Stranded |
| Remote Wiring Configuration Allowed | Yes      |

## Core & Coil (71A) MH ~LT~ 175W

|   |  |
|---|--|
| Max Ballast-Lamp Distance Remote Wiring | 25'  |
| Recommended Fuse Value                  | 5/3 A  |
| <b>Approval and Application</b>         |  |
| Open Circuit Voltage Test (Volts)       | 250-315 V                                      |
| Approval Marks                          | NOM certificate RoHS Compliant CSA certificate |
| Temperature Marking                     | A/B  |
| UL Recognized                           | Yes  |
| Hipot Test (1 Minute)                   | 2000 V   |
| Hipot Test (2 Seconds)                  | 2500 V   |
| UL Insulation Class                     | H(180°C)                                       |
| UL Temperature Code                     | 1029B  |

### Product Data

|                                 |  |
|---------------------------------|--|
| Order product name              | CORE & COIL HID MH BAL 100W M90/140 127/220V C&C |
| EAN/UPC - Product               | 781087034743                                     |
| Order code                      | 913710490702                                     |
| Numerator - Quantity Per Pack   | 1  |
| Numerator - Packs per outer box | 2  |
| Material Nr. (12NC)             | 913710490702                                     |
| Net Weight (Piece)              | 2.672 kg   |

### Dimensional drawing

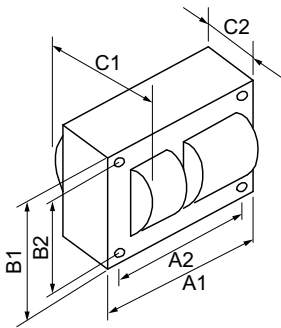

MH BAL 100W M90/140 127/220V C&C

| Product  | C1     | C2     | A1     | A2     | B1     | B2     |
|--|--------|--------|--------|--------|--------|--------|
| CORE & COIL HID MH BAL 100W M90/140 127/220V C&C | 2.9 in | 1.7 in | 3.9 in | 3.5 in | 2.8 in | 2.4 in |

