



Lighting



Core & Coil (71A) MH 175W - 450W

**CORE & COIL HID MH BAL 250W M58/H37 QUAD
C&C**

The basic ballast is the open core and coil which is most often used as a component within a lighting luminaire. The core and coil also forms the nucleus of Philips Advance's five other ballast configurations.

Product data

| General Information | |
|------------------------------------|------------------------|
| ANSI Code | M58 |
| Lamp Type | 250W MH |
| Number of Lamps | 1 piece/unit |
| Circuit Type | CWA |
| Ballast Type | Magnetic HID |
| Base Model | 71A5790A |
| Core Size | 4 1/4 x 4 3/4 (2 coil) |
| Suitable For Outdoor Use | Yes |
| Ignitor Catalog Number | NA |
| Ignitor Temperature Rating | NA |
| Capacitor Value | 15 MFD |
| Capacitor Catalog Number | 7C150P40R |
| Capacitor Requirements | 400V |
| Capacitor Temperature Rating | 105°C |
| Capacitor Diameter/Oval Dimensions | 1.75 in |
| Capacitor Height | 3.75 in |
| Automatic Restart | No |

| Operating and Electrical | |
|-------------------------------------|-------------------------------------|
| Input Voltage | 120/208/240/277 V |
| Input Frequency | 60 Hz |
| Inp. Current (Open Circuit) | 1.7/1/0.85/0.75 A |
| Input Current (Starting) | 2.2/1.3/1.1/1 A |
| Input Current (Short Circuit) | 1.9-2.7/1.1-1.7/0.95-1.35/0.8-1.2 A |
| Secondary Short Circuit Current | 2.25-2.75 A |
| Constant Wattage Deviation | 10% |
| Ballast Factor (Nom) | 1 |
| Power Factor (Nom) | 0.90 |
| Nominal Open Circuit Voltage | 300 V |
| Input Current (Operating) (Nom) | 2.5/1.45/1.25/1.1 A A |
| Input Power (Nom) | 298 W |
| Rated Lamp Watts | 250 W |
| | |
| Wiring | |
| Wire Striplength | 0.5 mm |
| Wire Length by Color | 12" |
| Wire Type | Stranded |
| Remote Wiring Configuration Allowed | Yes |

Core & Coil (71A) MH 175W - 450W

| | |
|---|--|
| Max Ballast-Lamp Distance Remote Wiring | Determined by AWG used |
| Recommended Fuse Value | 8/5/5/3 A |
| Approval and Application | |
| Open Circuit Voltage Test (Volts) | 270-330 V |
| Approbation Marks | ULR NOM certificate RoHS Compliant CSA certificate |
| Temperature Marking | B/B/B/B |
| UL Recognized | No |
| Hipot Test (1 Minute) | 2000 V |
| Hipot Test (2 Seconds) | 2500 V |
| UL Insulation Class | H(180°C) |

| | |
|---------------------------------|--|
| UL Temperature Code | 1029B |
| Product Data | |
| Order product name | CORE & COIL HID MH BAL 250W M58/H37 QUAD C&C |
| EAN/UPC - Product | 781087055069 |
| Order code | 71A5790500DA |
| Numerator - Quantity Per Pack | 1 |
| Numerator - Packs per outer box | 4 |
| Material Nr. (12NC) | 913710498910 |
| Net Weight (Piece) | 4.115 kg |

Dimensional drawing

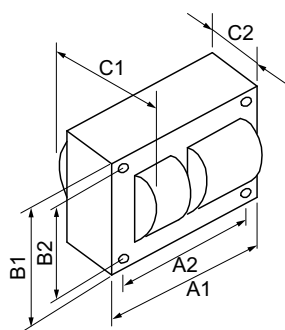

MH BAL 250W M58/H37 QUAD C&C

| Product | C1 | C2 | A1 | A2 | B1 | B2 |
|--|---------|--------|--------|--------|--------|--------|
| CORE & COIL HID MH BAL 250W M58/H37 QUAD C&C | 3.15 in | 1.5 in | 4.8 in | 4.4 in | 4.3 in | 3.9 in |

