

# Core & Coil (71A) MH 175W – 450W

## CORE & COIL HID MH BAL 400W M59 QUAD C&C

The basic ballast is the open core and coil which is most often used as a component within a lighting luminaire. The core and coil also forms the nucleus of Philips Advance's five other ballast configurations.

### Product data

General Information			
ANSI Code	M59	Input Frequency	60 Hz
Lamp Type	400W MH	Inp. Current (Open Circuit)	3/1.8/1.5/1.35 A
Number of Lamps	1 piece/unit	Input Current (Starting)	3.25/1.9/1.65/1.45 A
Circuit Type	CWA	Input Current (Short Circuit)	2.54-3.81/1.46-2.19/1.27-1.9/1.1-1.66 A
Ballast Type	Magnetic HID	Secondary Short Circuit Current	3.43-4.19 A
Base Model	71A6091A	Constant Wattage Deviation	10%
Core Size	4 1/4 x 4 3/4 (2 coil)	Ballast Factor (Nom)	1
Suitable For Outdoor Use	Yes	Power Factor (Nom)	0.90
Ignitor Catalog Number	NA	Nominal Open Circuit Voltage	305 V
Ignitor Temperature Rating	NA	Input Current (Operating) (Nom)	4/2.3/2/1.72 A A
Capacitor Value	24 MFD	Input Power (Nom)	455 W
Capacitor Catalog Number	7C240P40R	Rated Lamp Watts	400 W
Capacitor Requirements	400V		
Capacitor Temperature Rating	105°C		
Capacitor Diameter/Oval Dimensions	1.75 in		
Capacitor Height	4.80 in		
Automatic Restart	No		
Operating and Electrical			
Input Voltage	120/208/240/277 V		

Wiring	
Wire Striplength	0.5 mm
Wire Length by Color	12"
Wire Type	Stranded
Remote Wiring Configuration	Yes
Allowed	
Max Ballast-Lamp Distance Remote	Determined by AWG used
Wiring	

## Core & Coil (71A) MH 175W - 450W

Recommended Fuse Value	10/7/5/5 A
<b>Approval and Application</b>	
Open Circuit Voltage Test (Volts)	275-335 V
Approbation Marks	ULR CSA certificate RoHS Compliant
Temperature Marking	D/E/D/E
UL Recognized	Yes
Hipot Test (1 Minute)	2000 V
Hipot Test (2 Seconds)	2500 V
UL Insulation Class	H(180°C)
UL Temperature Code	1029E

<b>Product Data</b>	
Order product name	CORE & COIL HID MH BAL 400W M59 QUAD C&C
EAN/UPC - Product	781087069691
Order code	71A6091500DMLA
Numerator - Quantity Per Pack	1
Numerator - Packs per outer box	2
Material Nr. (12NC)	913710508319
Net Weight (Piece)	5.929 kg

### Dimensional drawing

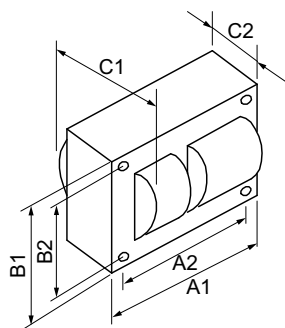

MH BAL 400W M59 QUAD C&C

Product	C1	C2	A1	A2	B1	B2
CORE & COIL HID MH BAL 400W M59 QUAD C&C	4 in	2.13 in	4.8 in	4.4 in	4.3 in	3.9 in

