



# Core & Coil (71A) HPS 200W - 400W

## CORE & COIL HID HPS BAL 400W S51 QUAD C&C

The basic ballast is the open core and coil which is most often used as a component within a lighting luminaire. The core and coil also forms the nucleus of Philips Advance's five other ballast configurations.

### Product data

General Information			
ANSI Code	S51-M169	Input Frequency	60 Hz
Lamp Type	400W HPS	Input Current (Open Circuit)	2/1.2/0.95/0.85 A
Number of Lamps	1 piece/unit	Input Current (Starting)	3.3/1.8/1.5/1.4 A
Circuit Type	CWA	Input Current (Short Circuit)	2.4-3.6/1.4-2.1/1.2-1.8/1-1.55 A
Ballast Type	Magnetic HID	Secondary Short Circuit Current	6-7.4 A
Base Model	71A8493A	Constant Wattage Deviation	Within Trapezoid
Core Size	4 x 4 (2 coil)	Ballast Factor (Nom)	1
Suitable For Outdoor Use	Yes	Power Factor (Nom)	0.90
Ignitor Catalog Number	LI501-H4	Open Circuit Voltage	190 V
Ignitor Temperature Rating	105°C	Input Current (Nom)	3.8/2.2/1.9/1.7 A A
Capacitor Value	55 MFD	Input Power (Nom)	464 W
Capacitor Catalog Number	7C550P24RA	Rated Lamp Power	400 W
Capacitor Requirements	240V	Wiring	
Capacitor Temperature Rating	105°C	Wire Striplength	0.5 mm
Capacitor Diameter/Oval Dimensions	1.85 in	Wire Length by Color	12"
Capacitor Height	3.70 in	Wire Type	Stranded
Automatic Restart	No	Remote Wiring Configuration Allowed	Yes
Operating and Electrical		Max Ballast-Lamp Distance Remote	2'
Input Voltage	120/208/240/277 V	Wiring	

## Core & Coil (71A) HPS 200W - 400W

Recommended Fuse Value	10/8/5/5 A
<b>Approval and Application</b>	
Open Circuit Voltage Test (Volts)	170-210 V
Approval Marks	ULR CSA certificate RoHS Compliant
Temperature Marking	D/D/D/D
UL Recognized	Yes
Hipot Test (1 Minute)	2000 V
Hipot Test (2 Seconds)	2500 V
UL Insulation Class	H(180°C)
UL Temperature Code	1029D

<b>Product Data</b>	
Order product name	CORE & COIL HID HPS BAL 400W S51 QUAD C&C
EAN/UPC - Product	781087121184
Order code	913710551202
Numerator - Quantity Per Pack	1
Numerator - Packs per outer box	3
Material Nr. (12NC)	913710551202
Net Weight (Piece)	6.564 kg

### Dimensional drawing

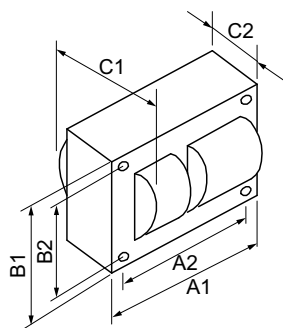

Product	C1	C2	A1	A2	B1	B2
CORE & COIL HID HPS BAL 400W S51 QUAD C&C	4.30 in	2.65 in	4.8 in	4.4 in	4.3 in	3.9 in

HPS BAL 400W S51 QUAD C&C

