



# Core & Coil (71A) MH ~GT~ 450W

## CORE & COIL HID MH BAL 1000W M141 QUAD C&C

The basic ballast is the open core and coil which is most often used as a component within a lighting luminaire. The core and coil also forms the nucleus of Philips Advance's five other ballast configurations.

### Product data

| General Information                |                        | Operating and Electrical            |                                |
|------------------------------------|------------------------|-------------------------------------|--------------------------------|
| ANSI Code                          | M141                   | Input Voltage                       | 120/208/240/277 V              |
| Lamp Type                          | 1000W MH               | Input Frequency                     | 60 Hz                          |
| Number of Lamps                    | 1 piece/unit           | Input Current (Open Circuit)        | 5/2.7/2.5/2.2 A                |
| Circuit Type                       | CWA                    | Input Current (Starting)            | 7/4/3.5/3 A                    |
| Ballast Type                       | Magnetic HID           | Input Current (Short Circuit)       | 5.3-8/3.1-4.7/2.65-4/2.3-3.5 V |
| Base Model                         | 71A6591                | Secondary Short Circuit Current     | 4.9-6.1 A                      |
| Core Size                          | 4 1/4 x 4 3/4 (2 coil) | Constant Wattage Deviation          | 10%                            |
| Suitable For Outdoor Use           | Yes                    | Ballast Factor (Nom)                | 1                              |
| Ignitor Catalog Number             | LI572-H5               | Power Factor (Nom)                  | 0.90                           |
| Ignitor Temperature Rating         | 105°C                  | Open Circuit Voltage                | 415 V                          |
| Capacitor Value                    | 24 MFD                 | Input Current (Nom)                 | 9/5.2/4.5/3.9 A A              |
| Capacitor Catalog Number           | MD2409000              | Input Power (Nom)                   | 1070 W                         |
| Capacitor Requirements             | 480V                   | Rated Lamp Power                    | 1000 W                         |
| Capacitor Temperature Rating       | 90°C                   |                                     |                                |
| Capacitor Diameter/Oval Dimensions | 1.75 in                | Wiring                              |                                |
| Capacitor Height                   | 3.9 in                 | Wire Striplength                    | 0.5 mm                         |
| Automatic Restart                  | No                     | Wire Length by Color                | 12"                            |
|                                    |                        | Wire Type                           | Stranded                       |
|                                    |                        | Remote Wiring Configuration Allowed | Yes                            |

## Core & Coil (71A) MH ~GT~ 450W

|                                   |                                    |
|-----------------------------------|------------------------------------|
| Max Ballast-Lamp Distance Remote  | 5'                                 |
| Wiring                            |                                    |
| Recommended Fuse Value            | 20/15/10/10 A                      |
| <b>Approval and Application</b>   |                                    |
| Open Circuit Voltage Test (Volts) | 370-460 V                          |
| Approval Marks                    | ULR CSA certificate RoHS Compliant |
| Temperature Marking               | A/A/A/A                            |
| UL Recognized                     | Yes                                |
| Hipot Test (1 Minute)             | 1500 V                             |
| Hipot Test (2 Seconds)            | 2500 V                             |
| UL Insulation Class               | N(AC200°C)                         |
| UL Temperature Code               | 1029A                              |

### Product Data

|                                 |  |
|---------------------------------|--|
| Order product name              | CORE & COIL HID MH BAL 1000W M141 QUAD C&C |
| EAN/UPC - Product               | 781087035405                               |
| Order code                      | 913710589502                               |
| Numerator - Quantity Per Pack   | 1  |
| Numerator - Packs per outer box | 2  |
| Material Nr. (12NC)             | 913710589502                               |
| Net Weight (Piece)              | 9.140 kg                                   |

### Dimensional drawing

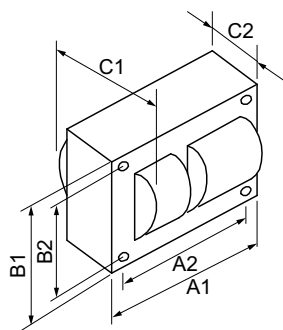

MH BAL 1000W M141 QUAD C&C

| Product                    | C1      | C2      | A1     | A2     | B1     | B2     |
|----------------------------|---------|---------|--------|--------|--------|--------|
| CORE & COIL HID 71A6591500 | 5.25 in | 3.32 in | 4.8 in | 4.4 in | 4.3 in | 3.9 in |

