



Core & Coil (71A) MH

175W - 450W

**CORE & COIL HID MH BAL 400W M59
120/277/347V C&C**

The basic ballast is the open core and coil which is most often used as a component within a lighting luminaire. The core and coil also forms the nucleus of Philips Advance's five other ballast configurations.

Product data

General Information	
ANSI Code	M59
Lamp Type	400W MH
Number of Lamps	1 piece/unit
Circuit Type	CWA
Ballast Type	Magnetic HID
Base Model	71A60A1A
Core Size	4 1/4 x 4 3/4 (2 coil)
Suitable For Outdoor Use	Yes
Ignitor Catalog Number	NA
Ignitor Temperature Rating	NA
Capacitor Value	24 MFD
Capacitor Catalog Number	7C240P40R
Capacitor Requirements	400V
Capacitor Temperature Rating	105°C
Capacitor Diameter/Oval Dimensions	1.75 in
Capacitor Height	4.80 in
Automatic Restart	No

Operating and Electrical

Input Voltage	120/277/347 V
Input Frequency	60 Hz
Input Current (Open Circuit)	2.6/1.2/0.9 A
Input Current (Starting)	2.6/1.2/0.9 A
Input Current (Short Circuit)	2.75-4.2/1.2-1.8/0.95-1.45 A
Secondary Short Circuit Current	3.5-4.3 A
Constant Wattage Deviation	10%
Ballast Factor (Nom)	1
Power Factor (Nom)	0.90
Open Circuit Voltage	300 V
Input Current (Nom)	4/1.75/1.4 A A
Input Power (Nom)	460 W
Rated Lamp Power	400 W

Wiring

Wire Striplength	0.5 mm
Wire Length by Color	12"
Wire Type	Stranded
Remote Wiring Configuration Allowed	Yes

Core & Coil (71A) MH 175W - 450W

Max Ballast-Lamp Distance Remote	Determined by AWG used
Wiring	
Recommended Fuse Value	10/5/4 A

Approval and Application

Open Circuit Voltage Test (Volts)	270-330 V
Approval Marks	ULR CSA certificate RoHS Compliant
Temperature Marking	D/D/D
UL Recognized	Yes
Hipot Test (1 Minute)	2000 V
Hipot Test (2 Seconds)	2500 V
UL Insulation Class	H(180°C)
UL Temperature Code	1029D

Product Data

Order product name	CORE & COIL HID MH BAL 400W M59 120/277/347V C&C
EAN/UPC - Product	781087051818
Order code	913710603702
Numerator - Quantity Per Pack	1
Numerator - Packs per outer box	4
Material Nr. (12NC)	913710603702
Net Weight (Piece)	6.274 kg

Dimensional drawing

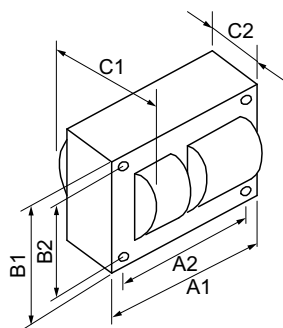

MH BAL 400W M59/H33 120/277/347V C&C

Product	C1	C2	A1	A2	B1	B2
CORE & COIL HID 71A60A1600A	4 in	2.15 in	4.8 in	4.4 in	4.3 in	3.9 in

