

# Core & Coil (71A) MH 175W - 450W

## CORE & COIL HID MH BAL 250W M58 120/277/347V C&C

The basic ballast is the open core and coil which is most often used as a component within a lighting luminaire. The core and coil also forms the nucleus of Philips Advance's five other ballast configurations.

### Product data

General Information	
ANSI Code	M58
Lamp Type	250W MH
Number of Lamps	1 piece/unit
Circuit Type	CWA
Ballast Type	Magnetic HID
Base Model	71A57A0
Core Size	4 1/4 x 4 3/4 (2 coil)
Suitable For Outdoor Use	Yes
Ignitor Catalog Number	NA
Ignitor Temperature Rating	NA
Capacitor Value	15 MFD
Capacitor Catalog Number	7C150P40R
Capacitor Requirements	400V
Capacitor Temperature Rating	105°C
Capacitor Diameter/Oval Dimensions	1.75 in
Capacitor Height	3.75 in
Automatic Restart	No

Operating and Electrical	
Input Voltage	120/277/347 V
Input Frequency	60 Hz
Inp. Current (Open Circuit)	2.1/0.9/0.75 A
Input Current (Starting)	2.2/1/0.8 A
Input Current (Short Circuit)	1.9-2.7/0.8-1.2/0.65-1 A
Secondary Short Circuit Current	2.25-2.75 A
Constant Wattage Deviation	10%
Ballast Factor (Nom)	1
Power Factor (Nom)	0.90
Nominal Open Circuit Voltage	315 V
Input Current (Operating) (Nom)	2.5/1.1/0.9 A A
Input Power (Nom)	295 W
Rated Lamp Watts	250 W

Wiring	
Wire Striplength	0.5 mm
Wire Length by Color	12"
Wire Type	Stranded
Remote Wiring Configuration Allowed	Yes

## Core & Coil (71A) MH 175W - 450W

<b>Max Ballast-Lamp Distance Remote Wiring</b>	Determined by AWG used
<b>Recommended Fuse Value</b>	8/3/3 A
<b>Approval and Application</b>	
<b>Open Circuit Voltage Test (Volts)</b>	280-345 V
<b>Approval Marks</b>	ULR CSA certificate RoHS Compliant
<b>Temperature Marking</b>	A/A/A
<b>UL Recognized</b>	Yes
<b>Hipot Test (1 Minute)</b>	2000 V
<b>Hipot Test (2 Seconds)</b>	2500 V
<b>UL Insulation Class</b>	H(180°C)
<b>UL Temperature Code</b>	1029A

<b>Product Data</b>	
<b>Order product name</b>	CORE & COIL HID MH BAL 250W M58 120/277/347V C&C
<b>EAN/UPC - Product</b>	781087067390
<b>Order code</b>	71A57A0600A
<b>Numerator - Quantity Per Pack</b>	1
<b>Numerator - Packs per outer box</b>	6
<b>Material Nr. (12NC)</b>	913710657502
<b>Net Weight (Piece)</b>	4.087 kg

### Dimensional drawing

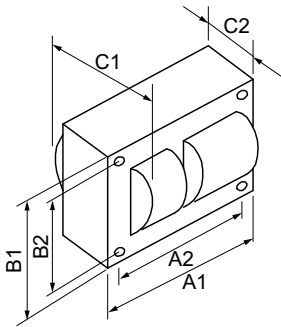

MH BAL 250W M58 120/277/347V C&C

Product	C1	C2	A1	A2	B1	B2
CORE & COIL HID 71A57A0600A	3.10 in	1.64 in	4.8 in	4.4 in	4.3 in	3.9 in

