



Core & Coil (71A) HPS 200W - 400W

CORE & COIL HID HPS BAL 250W S50 QUAD C&C

The basic ballast is the open core and coil which is most often used as a component within a lighting luminaire. The core and coil also forms the nucleus of Philips Advance's five other ballast configurations.

Product data

General Information			
ANSI Code	S50	Input Frequency	60 Hz
Lamp Type	250W HPS	Inp. Current (Open Circuit)	1.53/0.95/0.77/0.63 A
Number of Lamps	1 piece/unit	Input Current (Starting)	1.61/0.89/0.8/0.68 A
Circuit Type	CWA	Input Current (Short Circuit)	1.16-1.74/0.64-0.96/0.56-0.85/0.49-0.74 A
Ballast Type	Magnetic HID	Secondary Short Circuit Current	3.65-4.45 A
Base Model	71A8291A	Constant Wattage Deviation	Within Trapezoid
Core Size	4 x 4 (2 coil)	Ballast Factor (Nom)	1
Suitable For Outdoor Use	Yes	Power Factor (Nom)	0.90
Ignitor Catalog Number	LI501-H4	Nominal Open Circuit Voltage	187 V
Ignitor Temperature Rating	105°C	Input Current (Operating) (Nom)	2.5/1.47/1.25/1.09 A A
Capacitor Value	35 MFD	Input Power (Nom)	295 W
Capacitor Catalog Number	7C350P24RA	Rated Lamp Watts	250 W
Capacitor Requirements	240V		
Capacitor Temperature Rating	105°C		
Capacitor Diameter/Oval Dimensions	1.65 in		
Capacitor Height	3.7 in		
Automatic Restart	No		
Operating and Electrical		Wiring	
Input Voltage	120/208/240/277 V	Wire Striplength	0.5 mm
		Wire Length by Color	12"
		Wire Type	Stranded
		Remote Wiring Configuration Allowed	Yes
		Max Ballast-Lamp Distance Remote	2'
		Wiring	

Core & Coil (71A) HPS 200W - 400W

Recommended Fuse Value	7/4/4/3 A
Approval and Application	
Open Circuit Voltage Test (Volts)	170-205 V
Approbation Marks	ULR CSA certificate RoHS Compliant
Temperature Marking	B/B/B/B
UL Recognized	Yes
Hipot Test (1 Minute)	2000 V
Hipot Test (2 Seconds)	2500 V
UL Insulation Class	H(180°C)
UL Temperature Code	1029B

Product Data	
Order product name	CORE & COIL HID HPS BAL 250W S50 QUAD C&C
EAN/UPC - Product	781087069486
Order code	71A8291500DMLA
Numerator - Quantity Per Pack	1
Numerator - Packs per outer box	2
Material Nr. (12NC)	913710664002
Net Weight (Piece)	5.113 kg

Dimensional drawing

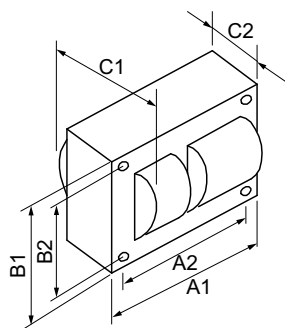

Product	C1	C2	A1	A2	B1	B2
CORE & COIL HID HPS BAL 250W S50 QUAD C&C	3.82 in	1.8 in	4.8 in	4.4 in	4.3 in	3.9 in

HPS BAL 250W S50 QUAD C&C

